

INSTRUCTION BOOK AND PARTS LIST



EASTMAN'S NEW **ULTRONIC**[®] **CUTTING MACHINE**

Eastmanmachine
COMPANY

779 WASHINGTON STREET
BUFFALO, NEW YORK 14203

ULTRONIC®

OPERATION, LUBRICATION AND CARE

Read this page before operating this machine.

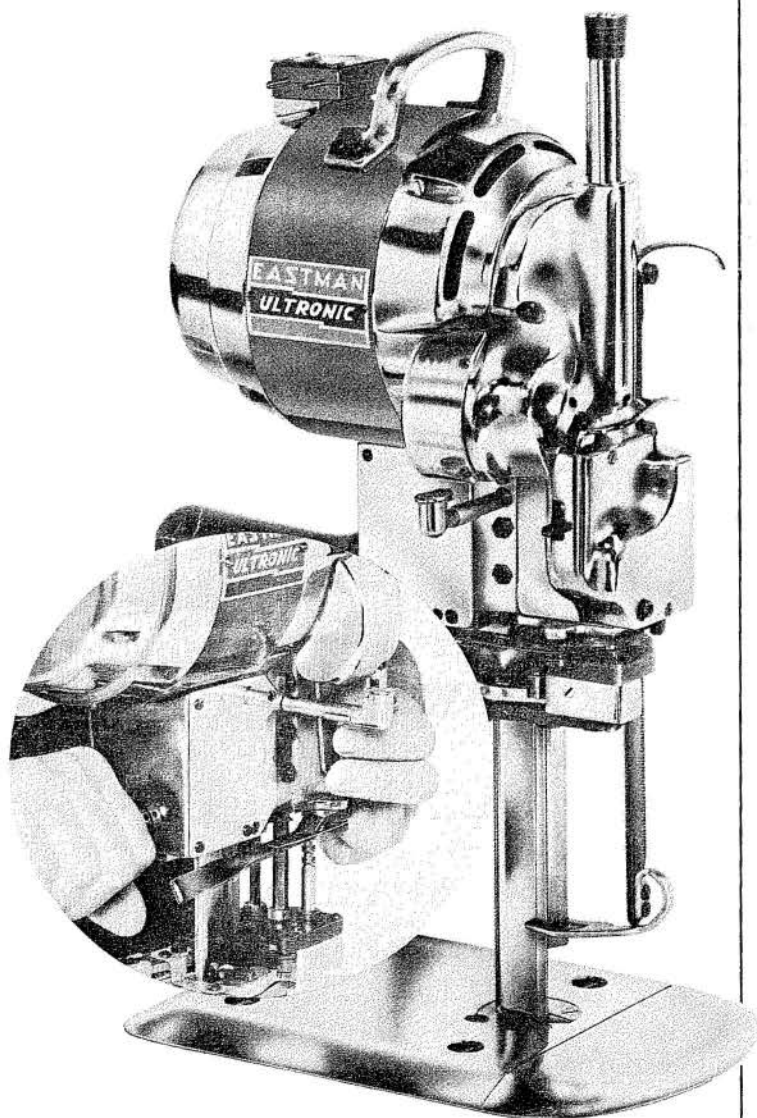

BEFORE STARTING

IN COLD WEATHER,
PLEASE KEEP MACHINE IN WARM PLACE.
Fill oil cups A, B and C.

Make sure sharpener is in locked position.
Push in turning knob F and turn the machine over
a few revolutions by hand to see if knife
moves easily. If knife does not move easily,
sharpener is probably in an unlocked position.
Use bell crank release lever H (see photo, at left)
to return sharpener to locked position.

Proceed as follows:—Check to see that motor
switch is in off position. Connect attachment plug
to terminal block on machine.

With left hand straddle front of sharpener
with fingers and thumb - Press in release lever H
to dis-engage sharpener mechanism from motor.
With right hand turn on motor switch,
allow motor to gather full speed
and then release lever H.

This will automatically return sharpener
to locked position. Knife must be in machine.

WARNING

For 3-phase machines direction of rotation
must be as indicated by arrow
on turning knob F. See tag attached to all
3-phase machines for instructions.

For the first week or two, or after the
machine has been idle for any length of time,
the motor should be turned on and off
a few times before allowing it
to run continuously.

This permits the oil to warm up and flow easily
into the closely fit moving parts.

CARE OF MACHINE

Use air hose or bellows and blow lint out of motor
and sharpener twice a week. Remove cover Q and
clean out lint around screw mechanism in
sharpener once a week. Remove knife and clean
knife slides with slot cleaner at least once a day.
To prevent undue accumulation of lint,
do not oil plate rollers. If rollers stick,
remove from plate and wash in cleaning solvent.

TO SHARPEN THE KNIFE

Take the machine out of the lay.
Drop pressure foot by means of pressure foot
lever R located next to machine operating handle.
Press lever E downward with a slow, firm pressure
to engage sharpening mechanism.
Too fast lever action may cause lever to lock.
If this occurs, lift lever D and start over.
After a few tries you will feel
correct operating pressure.

WARNING

Do not operate sharpener without knife
in machine or the sharpener
will be damaged. Do not shut off motor
while sharpener is in motion.

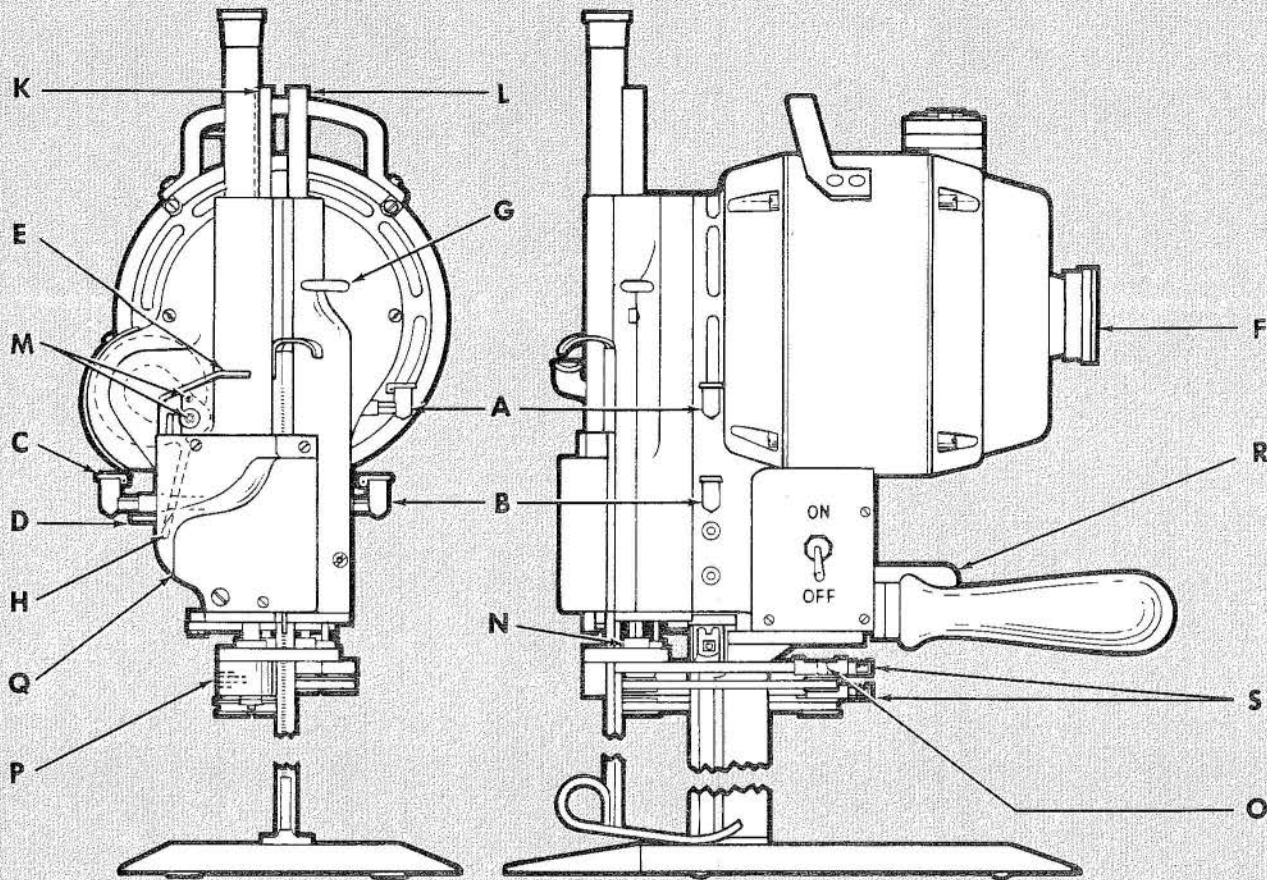

LUBRICATION

EVERY 2 HOURS - DAILY	ONCE A DAY	ONCE A WEEK	ONCE A MONTH
Fill oil cups A-B-C. Oil connecting rod bearing G. To oil, drop pressure foot rod and turn crank until you see connecting rod shaft through hole G. Use can with small spout (furnished with machine.) Insert spout in hole in shaft and oil.	Oil 2 places at M - use can with small spout (furnished with machine.)	One drop only to: Tubes at K & L Turning Knob at F Pulley Shaft N Belt Pulleys O	Remove plug at P and insert grease tube. Squeeze an amount about equal to the size of a pea into opening.

DO NOT USE AN EXCESS AMOUNT OF OIL

CAUTION

Do not use sewing machine oil or detergent oil. It is entirely too light for cutting machine lubrication. For best results use specially compounded Eastman oil or at least a good grade of No. 30 motor oil. Do not oil Base Plate Rollers.

Eastmanmachine
COMPANY

778 WASHINGTON STREET
BUFFALO, NEW YORK 14203

ULTRONIC[®] BELT SHARPENER ADJUSTMENT INSTRUCTIONS

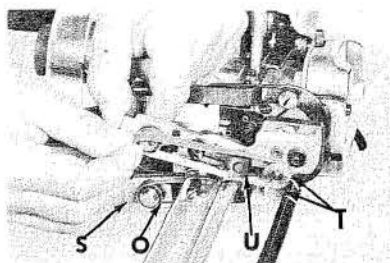

TO CHANGE SHARPENER BELTS

Push brackets S inward to release tension and remove worn belts. Place new belt over front pulley T, then between sharpener shoe U and knife and then over rear pulley O. Sharpener belts are available in 4 grits: Rough, Coarse, Medium and Fine.

ADJUST STABILIZERS FOR CENTRAL ALIGNMENT

Disengage attachment plug. Depress sharpener lever (E) halfway and lower belt carrier to extreme bottom position. (See page 3) Loosen screws (1) and disengage back guide (6) from contact with standard. Loosen screws (2) and disengage stabilizers (4) and (5). Remove locknut (3). Install Gauge #G189 on exposed threaded end of pivot screw (7) and press end of gauge against side of standard. Hold this position, engage opposite Stabilizer (4) firmly against side of standard and tighten screws (2). Remove tool #G189, press positioned stabilizer (4) against side of standard, fasten opposite stabilizer (5) firmly against standard. Replace locknut (7). Re-engage back guide (6) in loose contact with back of standard.

CHECK SHARPENER SHOES AND CLAMPING ARM

Shoes should swing in and out freely without excessive up and down play. If adjustment is necessary, loosen locknuts (3), tighten screws (7) as required.

Check Clamping Arm (10) with the belt carrier in the most downward position and the knife in the most upward position. Clamping Arm should hold shoe from moving in. If it fails to do so, serrations on clamping arm are worn or shoe (11) is worn. Parts should be replaced.

CHECK EXTREME DOWN POSITION OF SHARPENER

Correct down position is having the tip of the knife at the center of the belt on shoe (12) when the belt carrier is in

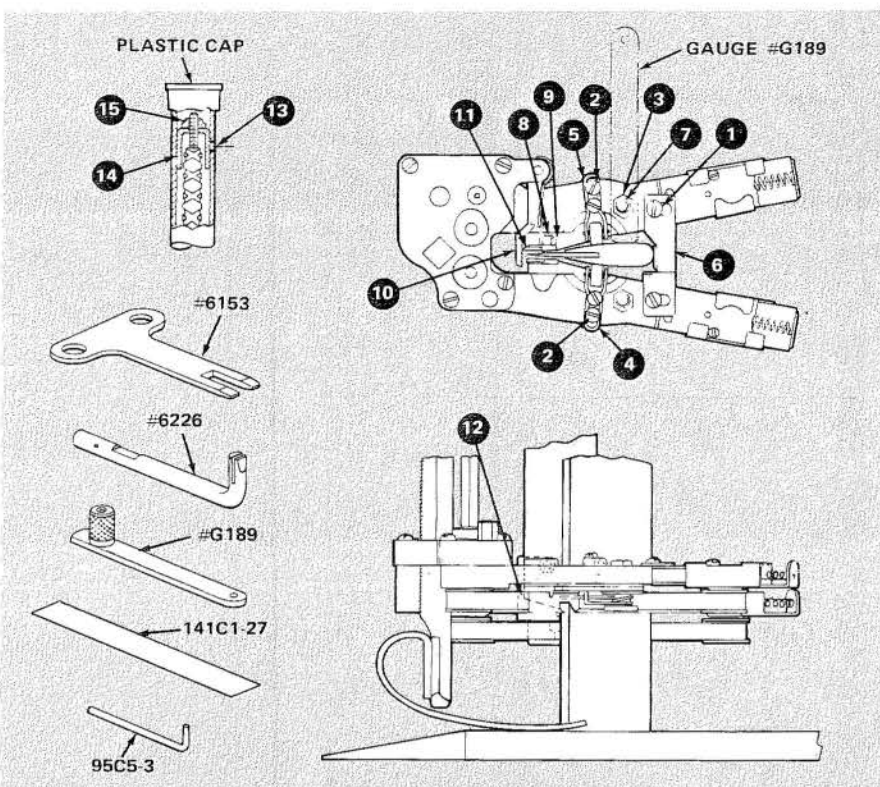

the most downward position and the knife is in the most upward position. If the belts are too high, the bottom point of the knife will not sharpen, if the belts are too low, the bottom point of the knife will round off excessively.

If adjustment is necessary, raise belt carrier to up position. Remove plastic cap from tube for screw shaft. Use pin through hole in tube (13) to prevent spacer (14) from turning, remove locknut (15). Turn spacer clockwise with wrench #6153 to raise bottom position and counter clockwise to lower position. One turn adjusts 1/32". When spacer is adjusted use pin to hold spacer in position, re-assemble and tighten locknut (15). Replace plastic cap.

CHECK STOP SCREW (8) ON SHARPENER SHOE

With new belts on carrier, insert .010 feeler gauge #141C1-27 between stop

screw and knife and be sure that clamping arm (10) has been released from Sharpener shoe (11). The gauge should just fill space between screw and knife. If adjustment is necessary, loosen locknut (9) adjust set screw to proper spacing and retighten locknut.

CHECK WIDTH OF BEVEL ON KNIFE

Bevel should be approximately 1/16" on both sides. Install new knife and new belts. Color bevel with blue pencil. Run sharpener up and down several times. If adjustment is required: for Flex-Pad shoes insert Tool #6226 over the belt guide pad and move free end of tool to the rear to increase the bevel, to the front to decrease the bevel.

ALL SPECIAL TOOLS FOR SHARPENER ADJUSTMENT CAN BE OBTAINED BY ORDERING TOOL KIT #820C2.

Eastman machine
COMPANY

779 WASHINGTON STREET
BUFFALO, NEW YORK 14203

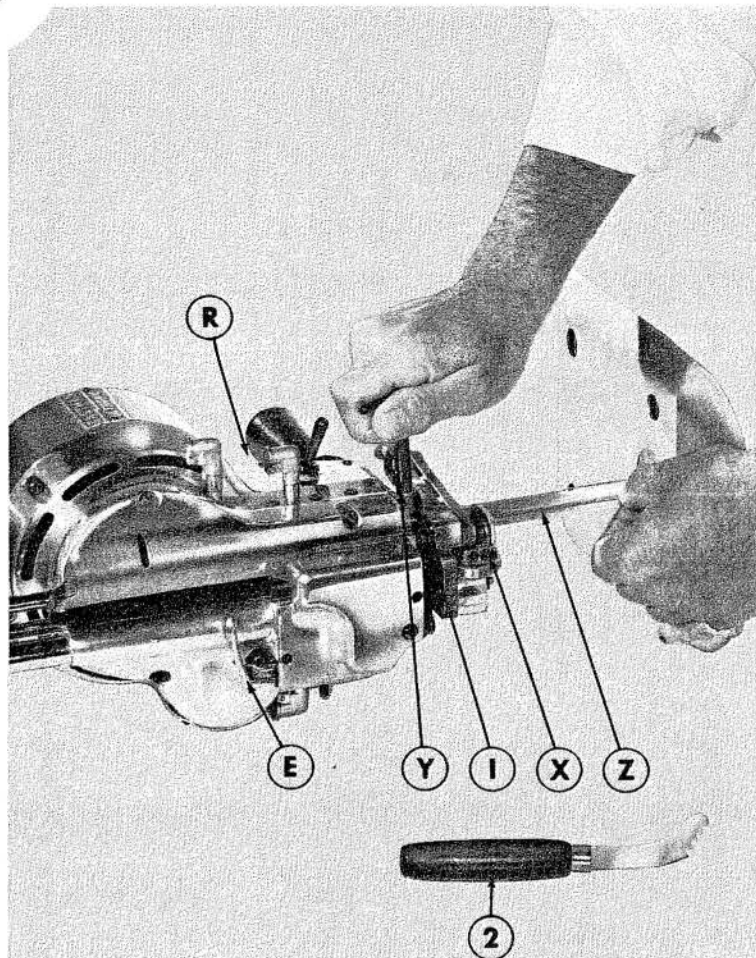

TO CHANGE THE KNIFE

Make sure sharpener is in locked position. Raise pressure foot X to top position by means of pressure foot lever R, located next to machine operating handle. Lay machine on table as shown. Press in turning knob F and turn knife to bottom position. Insert T-handle knife bolt wrench Y as shown and loosen knife lockbolt (1). Remove knife through bottom of standard Z. After removing knife, clean knife slot in standard with slot cleaner (2). Insert new knife in knife slot. Be sure to set knife tightly up against knife lock bolt and at the same time hold the bottom of the knife against the back of the slot in the standard when tightening knife lockbolt. After tightening knife lockbolt, check to see if knife runs freely in standard by rotating turning knob. Install new sharpener belts and operate sharpener three or four times before starting to cut.

WAVE KNIVES REQUIRE SPECIAL SHOES AND RELATED PARTS LISTED BELOW

743C1-27	L.H. SHOE	743C1-26	R.H. SHOE
34C10-47	L.H. SPRING	34C10-57	R.H. SPRING
20C12-57	SCREW (For shoe)	20C12-57	SCREW (For shoe)

FOR
BEST
RESULTS
USE
ONLY
EASTMAN
KNIVES

The guarantee covering your Ultronic Straight knife is not valid if knives other than those manufactured by Eastman are used.



KNIFE SIZE	TYPE OF STEEL	STRAIGHT KNIFE	WAVE KNIFE
5"	Carbon	80C5	80C5-19
5"	High Speed	80C5HS	80C5-19HS
5"	Special Alloy	80C5SA	
6"	Carbon	80C6	80C6-19
6"	High Speed	80C6HS	80C6-19HS
6"	High Speed		80C6-19HS-G*
6"	Special Alloy	80C6SA	
7"	Carbon	80C7	80C7-19
7"	High Speed	80C7HS	80C7-19HS
7"	Special Alloy	80C7SA	
8"	Carbon	80C8	80C8-19
8"	High Speed	80C8HS	80C8-19HS
8"	Special Alloy	80C8SA	
9"	Carbon	80C9	80C9-19
9"	High Speed	80C9HS	80C9-19HS
9"	Special Alloy	80C9SA	
10"	Carbon	80C10	80C10-19
10"	High Speed	80C10HS	80C10-19HS
10"	Special Alloy	80C10SA	
11½"	Carbon	80C11½	
11½"	High Speed	80C11½HS	80C11½-19HS
13"	Carbon	80C13	
13"	High Speed	80C13HS	

G* - Grooved Wave

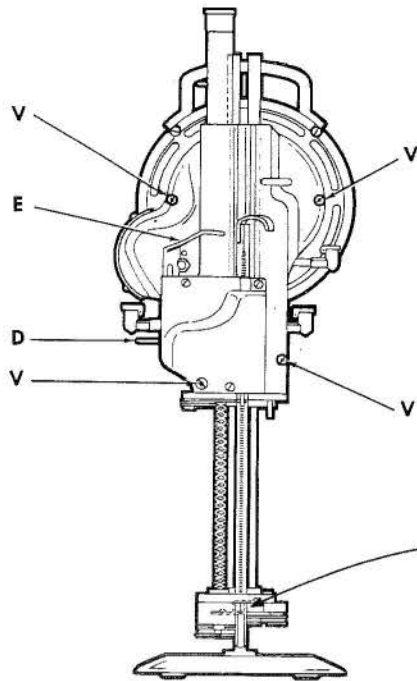

TO REMOVE SHARPENER

Press lever E approximately halfway down to neutral position and lower the sharpener by hand.

NOTE

If lever E is pressed too far down (beyond neutral position) it will lock the sharpener bracket. To release, lift lever D and start over.

Remove guide bracket. Press lever E to a neutral position and raise sharpener to original (top) position. Remove four hold down nuts V and remove sharpener.

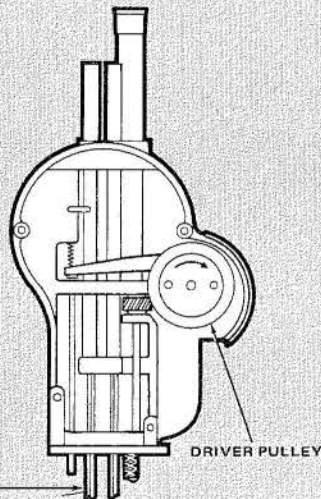
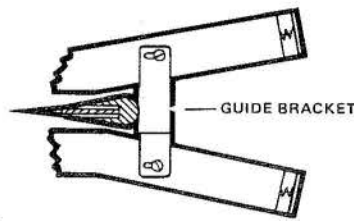

TO REPLACE RUBBER DRIVE PULLEY

The sharpener is driven by a rubber driver pulley which must be replaced when it wears down. To replace the rubber driver pulley proceed as follows: Remove sharpener from machine. See instructions above.

Press lever E to neutral position and lower sharpener until an inch of square shaft W is exposed. Hold square shaft W with wrench. Wrench position on shaft should be as close as possible to sharpener housing. Use spanner wrench to remove driver pulley by turning clockwise as indicated by arrow (pulley has left-hand thread.) Reassemble new pulley on sharpener. Reassemble sharpener on machine.

MAINTENANCE SUPPLIES

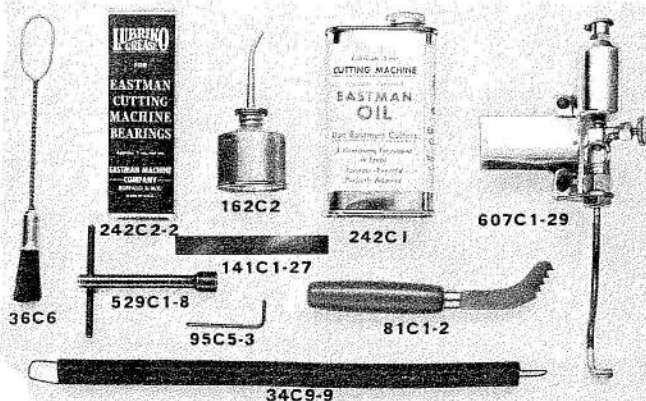

Part No.	Description
529C1-8	KNIFE BOLT WRENCH
95C5-3	ALLEN WRENCH FOR SHOE SET SCREWS
607C1-29	OILING DEVICE
242C2-2	EASTMAN BEARING GREASE
36C6	SHARPENER CLEANING BRUSH
141C1-27	FEELER GAUGE FOR SHOE SET SCREWS
162C2	OIL CAN
242C1	1/2 PINT EASTMAN OIL
81C1-2	SLOT CLEANER
34C9-9	TROLLEY SPRING

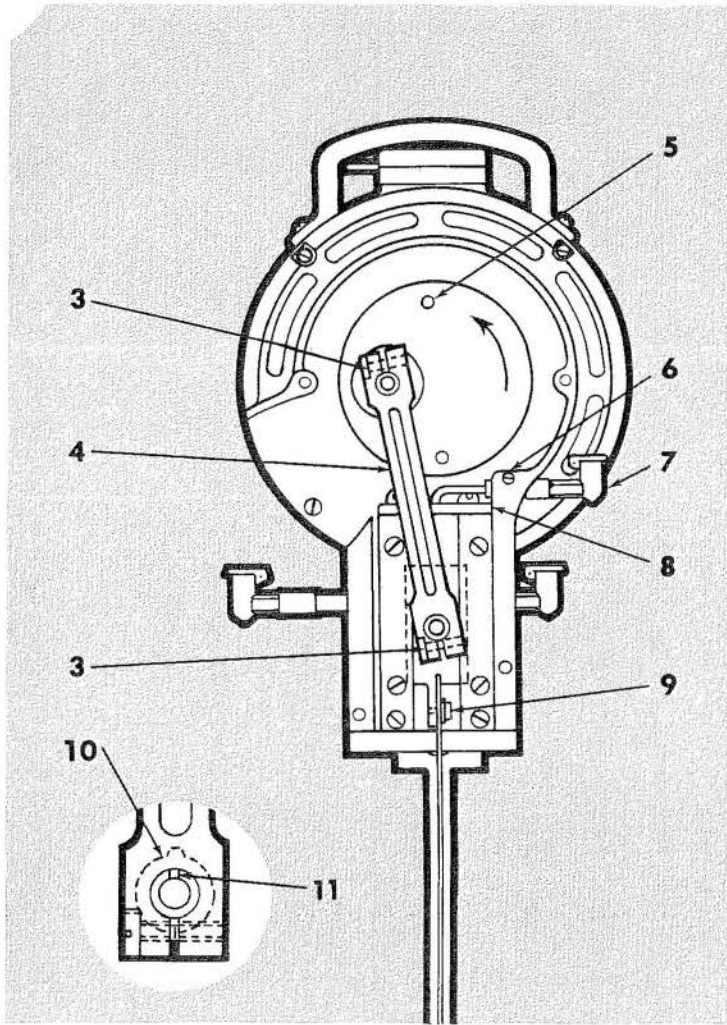

TO FREE FROZEN GUIDES

Remove sharpener from machine as explained on page 6. Remove knife. Loosen screws (3) and remove connecting rod (4). Insert drift pin in hole (5) in crank and tap with light hammer in direction of arrow. This will loosen crank. Remove crank. Loosen set screw (6) using No. 564 Allen Key (.078 hex) and remove oiler and tube (7). Remove oil pad holder (8). Remove crosshead (9) from guides. Use a fiber or brass rod against the bottom of crosshead and drive crosshead out through the top of the guides.

NOTE

If wrist pin is frozen in crosshead, drive wrist pin out of crosshead with soft punch. Polish wrist pin and hole in crosshead with fine emery cloth.

Hone rough spot on bearing surface of crosshead against a flat oilstone until smooth. Examine guides. If any evidence of high spot, remove with scraper and clean. Oil bearing surface of guides, insert crosshead and reassemble machine. Be sure washer (10) is in place between connecting rod and crosshead.

CAUTION

Wrist pin must be installed with notch (11) at top center. Otherwise flow of oil to wrist pin bearing will be cut off.

Run machine for approximately one-half hour, oiling guides frequently before putting machine back into production.

EASTMAN'S FOUR ABRASIVE BELT GRITS OFFER AN EDGE FOR EVERY FABRIC

For increased cutting efficiency, Eastman offers four different edges as produced by four different abrasive belts. These belt grits are available in convenient color-coded boxes for easy identification.

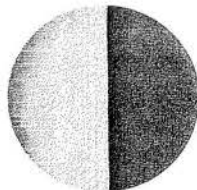
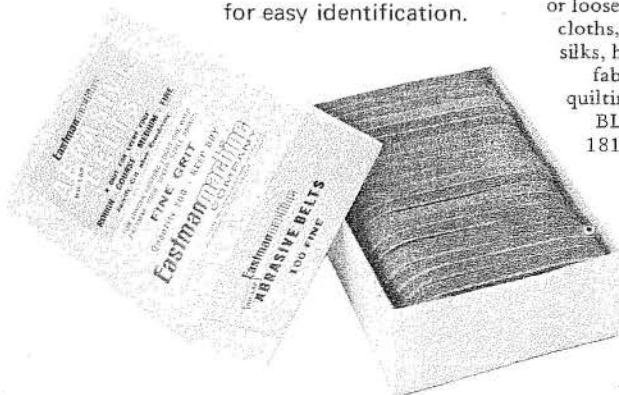

FINE BELT FINE EDGE

Slices thru synthetics and blends, for knitted or loosely woven cloths, and for silks, high pile fabrics, quilting, etc.
BLUE
181C2-5

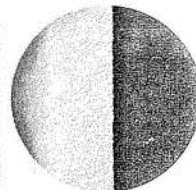

MEDIUM BELT MEDIUM EDGE

Shears thru the general run of rayons, cottons, light woolens, tropicals, suitings and similar materials.
GREEN
181C2-2

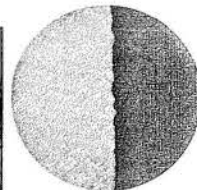

COARSE BELT COARSE EDGE

For heavier weight variations of the "medium" materials at left, and for tightly woven cloths, pocketing, light denims, over-coatings and light leatherette and rubberized fabrics.
RED
181C2-1

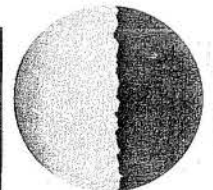

ROUGH BELT ROUGH EDGE

The edge that practically SAWS thru heavy denims, coated fabrics, treated canvas, simulated heavier leathers, etc.—where the going gets tough!
BLACK
181C2-6

250X micro-photos show four different edges as produced by EASTMAN'S four abrasive belt grits above.

... ONE JUST RIGHT FOR THE FABRIC YOU'RE CUTTING!

ILLUSTRATED PARTS LIST

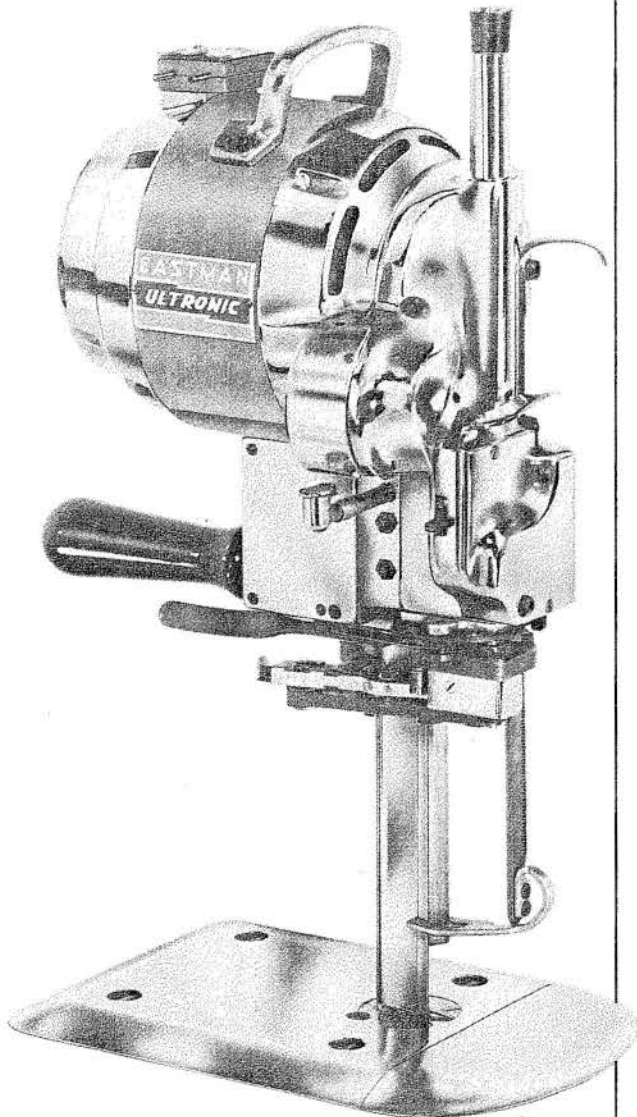

**EASTMAN'S
ULTRONIC®
625**

Your Eastman Ultronic Straight Knife has been carefully designed to provide many hours of trouble free operation. These comprehensive exploded parts illustrations have been carefully prepared to enable you to easily order replacement parts, as required. Replacement parts for this machine may be ordered thru your nearest Eastman representative or directly from the Eastman factory.

IMPORTANT

Always specify machine class number and serial number when ordering parts for faster more efficient service.

INDEX

EXPLODED PARTS ILLUSTRATIONS

The exploded parts illustrations and parts lists in this section have been divided into major assemblies as follows:

MOTOR ASSEMBLIES

Single Phase, Single Speed.....	Pages 10, 11
Single Phase, Dual Speed.....	Pages 10, 11
Three Phase, Single Speed	Pages 12, 13
Three Phase, Dual Speed	Pages 12, 13

FRONT BEARING HOUSING ASSEMBLY

See pages 14 and 15.

SHARPENER HOUSING ASSEMBLY

Front View see pages 16 and 17.

Rear View see pages 18 and 19.

LOWER GEAR BRACKET ASSEMBLY

See pages 20 and 21.

NOTE: FOUR DIFFERENT ABRASIVE BELT GRITS (DESIGNED TO PROVIDE YOU WITH A SELECTION OF EDGES) MAY BE ORDERED FOR THIS MACHINE. SEE PAGE 4 OF THIS MANUAL FOR MORE INFORMATION.

STANDARD AND BASE PLATE ASSEMBLY

See pages 22 and 23

NOTE: KNIFE SLIDE AND STANDARD HEIGHT INDICATED ON PAGES 22 AND 23 ARE BASED ON THE LENGTH OF KNIFE AND DO NOT REFER TO PHYSICAL DIMENSIONS. E.G. A 6" KNIFE SLIDE ACCOMODATES A 6" KNIFE. ORDERING INFORMATION AND PART NUMBERS FOR KNIVES MAY BE FOUND ON PAGE 5.

FASTENERS REQUIRED TO ASSEMBLE MAJOR COMPONENTS

Part No.	Description
4C1-99.....	SHARPENER HOLD DOWN NUT (3 Req'd.)
4C1-150.....	SHARPENER HOLD DOWN NUT (1 Req'd.)
4C1-179.....	FRONT TO REAR BEARING NUT (4 Req'd.)
4C2-2.....	PLATE BOLT NUT
20C3-29.....	FRONT TO REAR BEARING SCREW (4 Req'd.)
24C4.....	PLATE BOLT
307C18-1.....	STANDARD TO BEARING SCREW (4 Req'd.)

SHARPENER HOUSING ASSEMBLY (FRONT VIEW) SEE PAGES 16 AND 17

SHARPENER HOUSING ASSEMBLY (REAR VIEW) SEE PAGES 18 AND 19

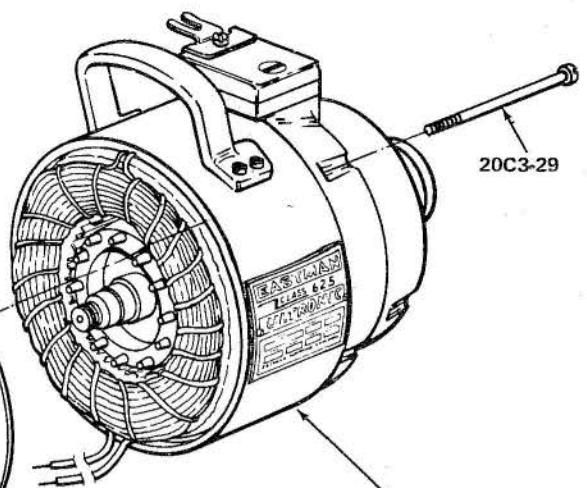

MOTOR ASSEMBLIES SEE PAGES 10, 11, 12 AND 13

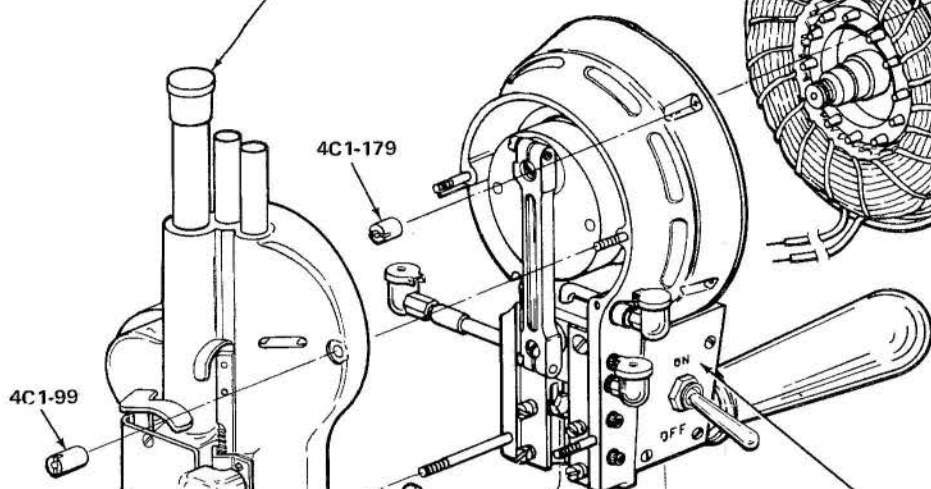

FRONT BEARING HOUSING ASSEMBLY SEE PAGES 14 AND 15

4C1-99

4C1-179

4C1-150

FOR KNIFE SEE PAGE 5

307C18-1

24C4

STANDARD and BASE PLATE ASSEMBLY SEE PAGES 22 AND 23

FOR REPLACEMENT BELTS SEE PAGE 4

LOWER GEAR BRACKET ASSEMBLY SEE PAGES 20 AND 21

4C2-2

Eastmanmachine COMPANY 779 WASHINGTON STREET BUFFALO, NEW YORK 14203

Eastmanmachine COMPANY

779 WASHINGTON STREET
BUFFALO, NEW YORK 14203

SINGLE PHASE MOTOR ASSEMBLIES

(SINGLE AND DUAL SPEED)

PLEASE SPECIFY
MACHINE CLASS NUMBER
AND SERIAL NUMBER
WHEN ORDERING PARTS

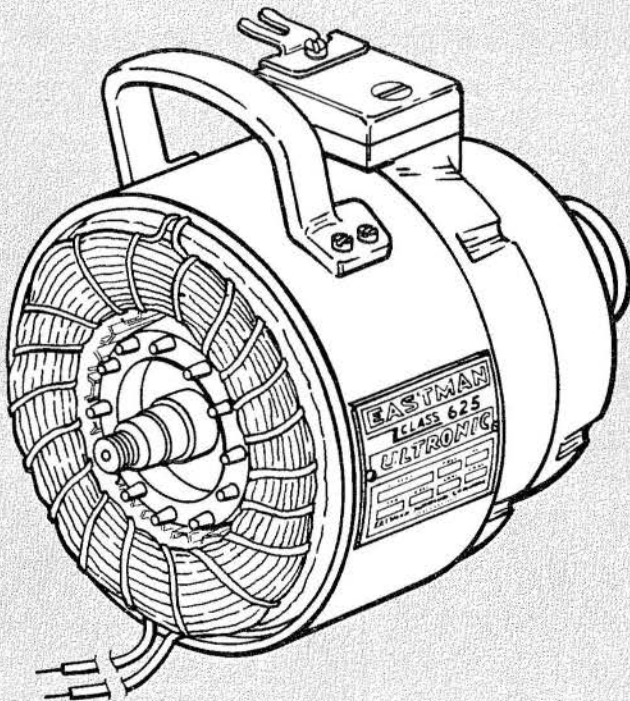

Part No.	Description
4C1-145	SHAFT LOCK NUT
4C2-87	CLUTCH NUT
8C12-4	LEAD WIRE INSULATION (2 Req'd.)
10C1-41	ROTOR FAN
12C1-12	LOADING SPRING WASHER
13C1-9	TURNING KNOB
18C6-16	RETAINING RING
20C12-2	TERMINAL SCREW (2 Req'd.)
22C1-24	CARRYING HANDLE
30C1-8	COVER FOR CUTOUT
34C1-51	CLUTCH SPRING
47C2-4	TERMINAL PIN (2 Req'd.)
51C1-16	TERMINAL BLOCK (Top)
51C1-17	TERMINAL BLOCK (Bottom)
53C7-35	FAN COVER
67C1-10	CUTOUT SWITCH MOUNT
73C7-121	TUBING FOR LEAD WIRES
79C12-107	GROUND CLIP
90C1-146	REAR BEARING HOUSING
90C6-28	REAR BALL BEARING
93C2-1	TERMINAL CONTACT (2 Req'd.)
300C12-5	SCREW, 8-32 x 7/16 ROUND HD. (2 Req'd.)
300C12-7	SCREW, 8-32 x 5/8 ROUND HD. (4 Req'd.)
301C8-1	SCREW, 4-40 x 1/2 FILLISTER HD. (3 Req'd.)
301C15-5	SCREW, 10-32 x 7/8 FILLISTER HD. (1 Req'd.)
302C15-6	SCREW, 10-32 x 7/8 FLAT HD. (1 Req'd.)
305C8-1	SCREW, 4-40 x 1/4 BINDING HD. (3 Req'd.)
508C1-19	TERMINAL BLOCK (Complete)
513C3-206	ROTOR WITH SHAFT
514C3-64	STATOR WITH BAND 110V. 50cy. 3000 R.P.M.
514C3-65	STATOR WITH BAND 110V. 50cy. 1500 R.P.M.
514C3-67	STATOR WITH BAND 110V. 60cy. 3600 R.P.M.
514C3-68	STATOR WITH BAND 110V. 60cy. 1800 R.P.M.
514C3-73	STATOR WITH BAND 220V. 50cy. 3000 R.P.M.
514C3-74	STATOR WITH BAND 220V. 50cy. 1500 R.P.M.
514C3-76	STATOR WITH BAND 220V. 60cy. 3600 R.P.M.
514C3-77	STATOR WITH BAND 220V. 60cy. 1800 R.P.M.
514C3-72	STATOR WITH BAND 150V. 60cy. 3600 R.P.M.
514C3-85	STATOR WITH BAND 250V. 50cy. 3000 R.P.M.
514C3-66	STATOR WITH BAND 110V. 50cy. 1500/3000 R.P.M.
514C3-69	STATOR WITH BAND 110V. 60cy. 1800/3600 R.P.M.
514C3-75	STATOR WITH BAND 220V. 50cy. 1500/3000 R.P.M.
514C3-78	STATOR WITH BAND 220V. 60cy. 1800/3600 R.P.M.
523C1-51	ATTACHMENT PLUG (Complete)
580C1-66	AUTOMATIC CUTOUT SWITCH—DUAL SPEED
580C1-70	AUTOMATIC CUTOUT SWITCH—SINGLE SPEED
597C2-14	AUTOMATIC CUTOUT 60cy. 3600 R.P.M.
597C2-15	AUTOMATIC CUTOUT 50cy. 3000 R.P.M.
597C2-16	AUTOMATIC CUTOUT 60cy. 1800 R.P.M.
597C2-17	AUTOMATIC CUTOUT 50cy. 1500 R.P.M.
597C2-15	AUTOMATIC CUTOUT 60cy. 1800/3600 R.P.M.
597C2-18	AUTOMATIC CUTOUT 50cy. 1500/3000 R.P.M.
615C1-7	ATTACHMENT PLUG CLAMP
667C1	TERMINAL CONTACT WITH PIN (2 Req'd.)
667C2	TERMINAL SLEEVE WITH CLIP (2 Req'd.)

SINGLE PHASE-SINGLE SPEED

- 514C3-64 110 V. 50 CY. 3000 R.P.M.
- 514C3-65 110 V. 50 CY. 1500 R.P.M.
- 514C3-67 110 V. 60 CY. 3600 R.P.M.
- 514C3-68 110 V. 60 CY. 1800 R.P.M.
- 514C3-73 220 V. 50 CY. 3000 R.P.M.
- 514C3-74 220 V. 50 CY. 1500 R.P.M.
- 514C3-76 220 V. 60 CY. 3600 R.P.M.
- 514C3-77 220 V. 60 CY. 1800 R.P.M.
- 514C3-72 150 V. 60 CY. 3600 R.P.M.
- 514C3-85 250 V. 50 CY. 3000 R.P.M.

SINGLE PHASE-DUAL SPEED

- 514C3-66 110 V. 50 CY. 1500/3000 R.P.M.
- 514C3-69 110 V. 60 CY. 1800/3600 R.P.M.
- 514C3-75 220 V. 50 CY. 1500/3000 R.P.M.
- 514C3-78 220 V. 60 CY. 1800/3600 R.P.M.

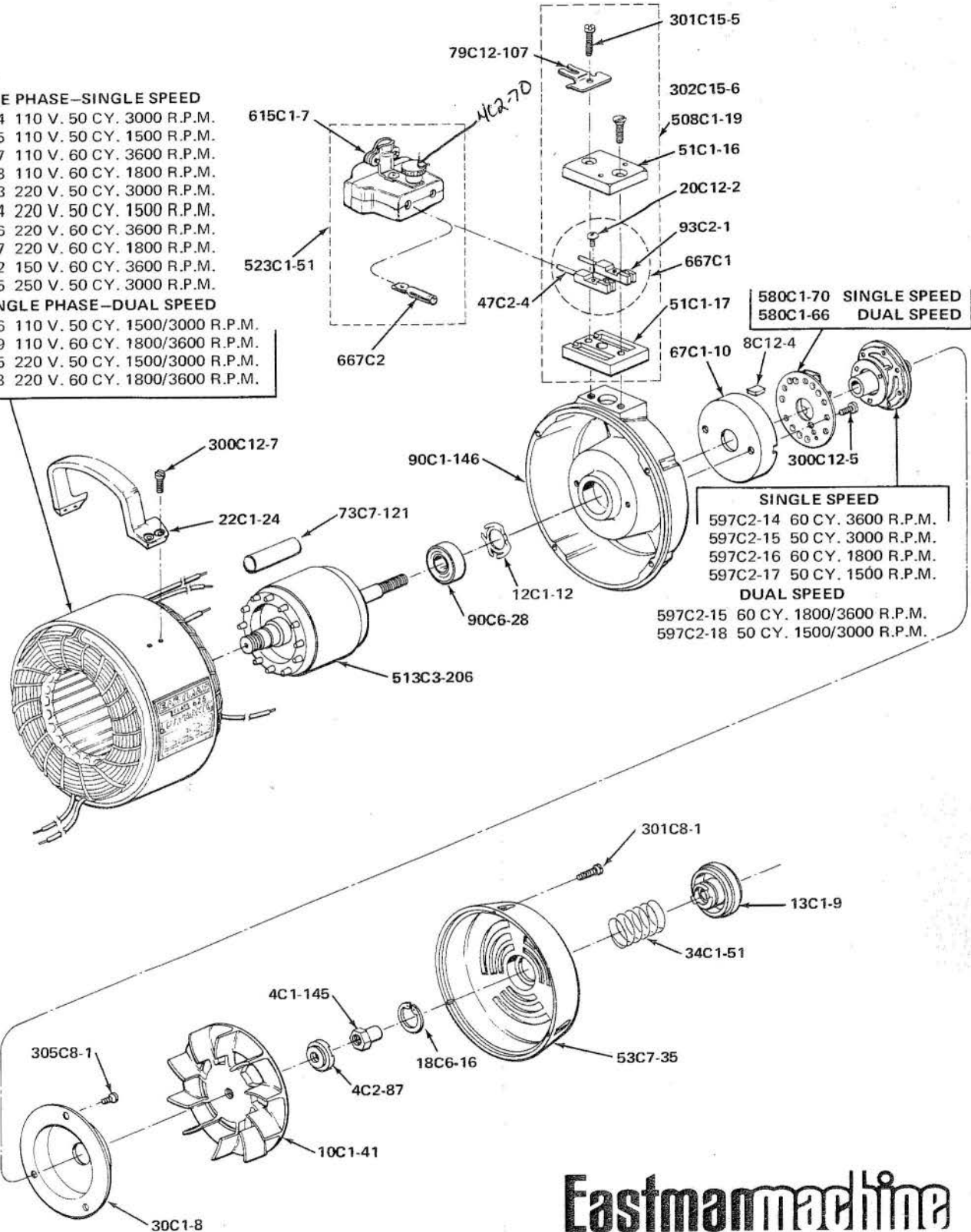

- 580C1-70 SINGLE SPEED
- 580C1-66 DUAL SPEED

- SINGLE SPEED**
- 597C2-14 60 CY. 3600 R.P.M.
 - 597C2-15 50 CY. 3000 R.P.M.
 - 597C2-16 60 CY. 1800 R.P.M.
 - 597C2-17 50 CY. 1500 R.P.M.
- DUAL SPEED**
- 597C2-15 60 CY. 1800/3600 R.P.M.
 - 597C2-18 50 CY. 1500/3000 R.P.M.

Eastmanmachine
COMPANY
 778 WASHINGTON STREET
 BUFFALO, NEW YORK 14203

PLEASE SPECIFY
MACHINE CLASS NUMBER
AND SERIAL NUMBER
WHEN ORDERING PARTS

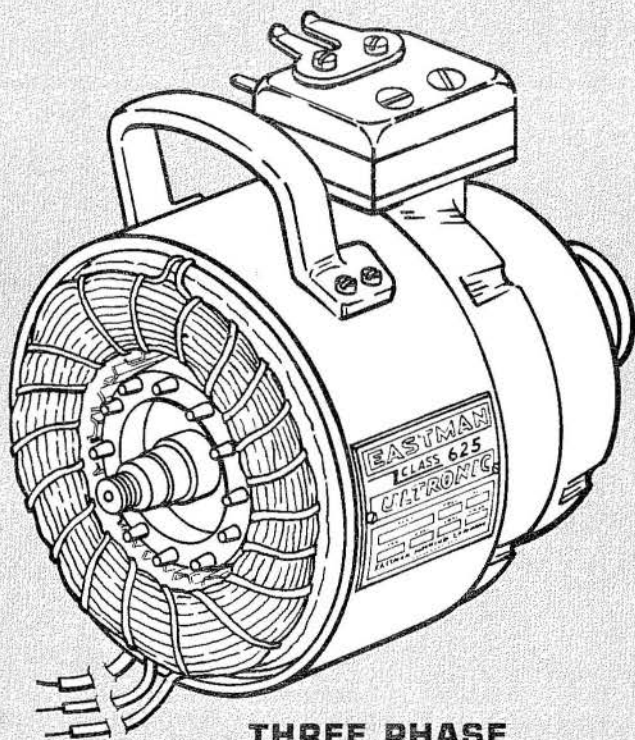

**THREE PHASE
MOTOR
ASSEMBLIES**

(SINGLE AND DUAL SPEED)

**Eastmanmachine
COMPANY**

779 WASHINGTON STREET
BUFFALO, NEW YORK 14203

Part No.	Description
1C4-8	SPACING SLEEVE
4C1-145	SHAFT LOCK NUT
4C2-87	CLUTCH NUT
10C1-41	ROTOR FAN
12C1-12	LOADING SPRING WASHER
13C1-9	TURNING KNOB
18C6-16	RETAINING RING
22C1-24	CARRYING HANDLE
29C6-67	TERMINAL BLOCK ADAPTER
34C1-51	CLUTCH SPRING
47C2-9	TERMINAL PIN (3 Req'd.)
47C3-17	TERMINAL SLEEVE (3 Req'd.)
51C1-18	TERMINAL BLOCK (Top)
51C1-19	TERMINAL BLOCK (Bottom)
53C7-35	FAN COVER
73C7-121	TUBING FOR LEAD WIRES
79C12-106	GROUND CLIP
90C1-146	REAR BEARING HOUSING
90C6-28	REAR BALL BEARING
300C12-3	SCREW, 8-32 x 3/8 ROUND HD. (2 Req'd.)
300C12-7	SCREW, 8-32 x 5/8 ROUND HD. (4 Req'd.)
301C8-1	SCREW, 4-40 x 1/2 FILLISTER HD. (3 Req'd.)
301C15-9	SCREW, 10-32 x 1 1/2 FILLISTER HD. (1 Req'd.)
301C15-12	SCREW, 10-32 x 1 1/8 FILLISTER HD. (1 Req'd.)
302C15-7	SCREW, 10-32 x 1 FLAT HD. (1 Req'd.)
302C15-11	SCREW, 10-32 x 1 1/2 FLAT HD. (1 Req'd.)
508C1-22	TERMINAL BLOCK (Complete)
513C3-206	ROTOR WITH SHAFT
514C3-79	STATOR WITH BAND 220V, 50cy. 3000 R.P.M.
514C3-80	STATOR WITH BAND 220V, 50cy. 1500 R.P.M.
514C3-81	STATOR WITH BAND 208V, 60cy. 3600 R.P.M.
514C3-82	STATOR WITH BAND 220V, 60cy. 3600 R.P.M.
514C3-83	STATOR WITH BAND 220V, 60cy. 1800 R.P.M.
514C3-84	STATOR WITH BAND 220V, 60cy. 1800/3600 R.P.M.
514C3-98	STATOR WITH BAND 220V, 50cy. 1500/3000 R.P.M.
523C1-38	ATTACHMENT PLUG (Complete)
615C1-5	ATTACHMENT PLUG CLAMP
667C1-1	CONTACT WITH PIN (3 Req'd.)

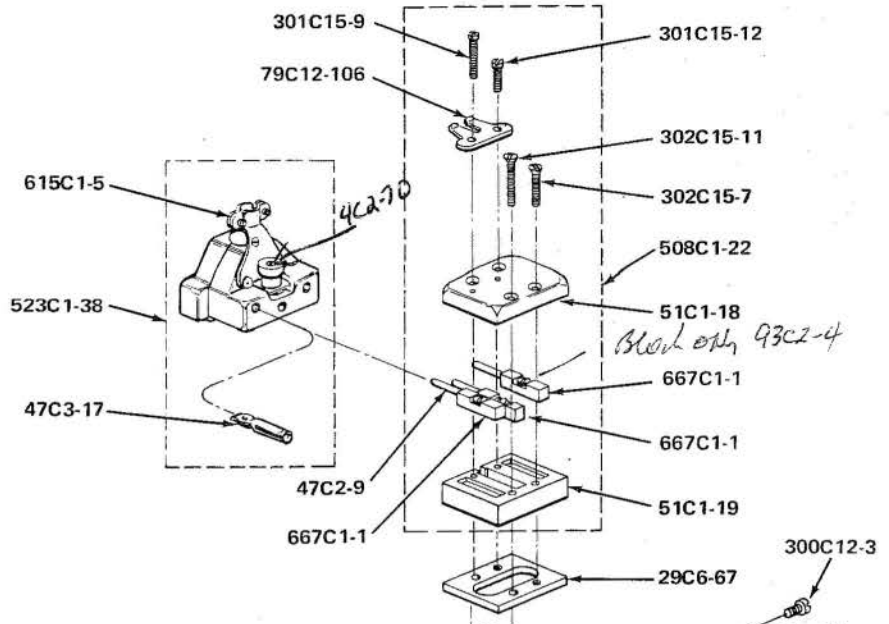

THREE PHASE-SINGLE SPEED

- 514C3-79 220 V. 50 CY. 3000 R.P.M.
- 514C3-80 220 V. 50 CY. 1500 R.P.M.
- 514C3-81 208 V. 60 CY. 3600 R.P.M.
- 514C3-82 220 V. 60 CY. 3600 R.P.M.
- 514C3-83 220 V. 60 CY. 1800 R.P.M.

THREE PHASE-DUAL SPEED

- 514C3-84 220 V. 60 CY. 1800/3600 R.P.M.
- 514C3-98 220 V. 50 CY. 1500/3000 R.P.M.

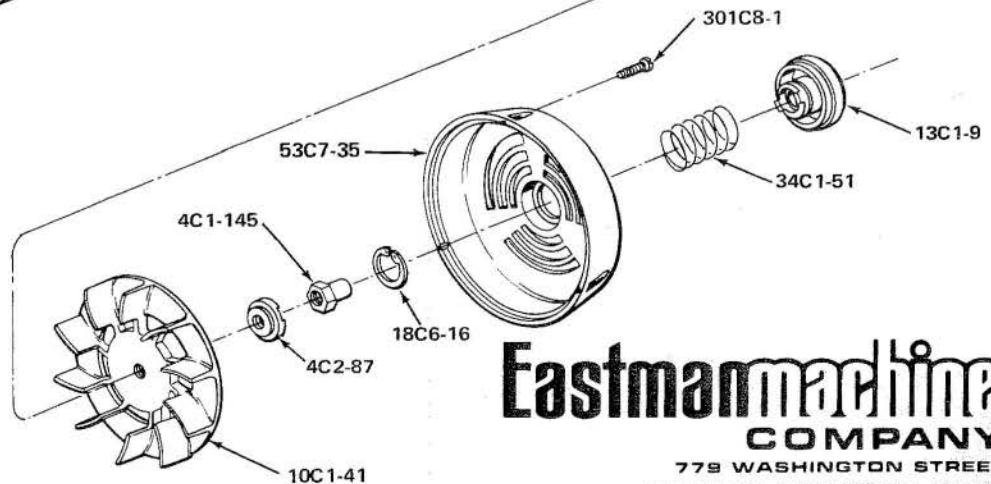
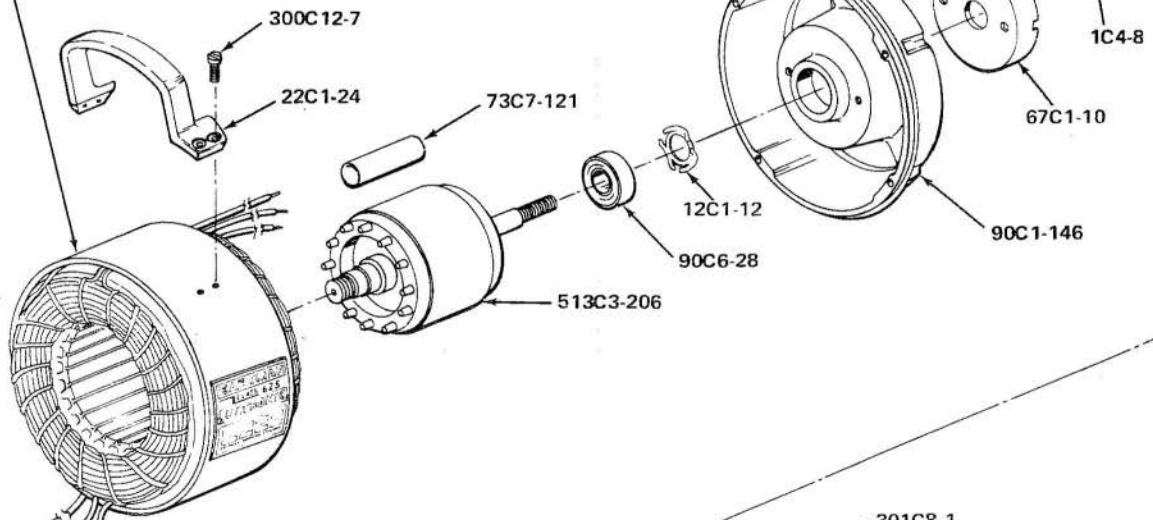

Eastmanmachine
COMPANY
 779 WASHINGTON STREET
 BUFFALO, NEW YORK 14203

Eastmanmachine COMPANY

779 WASHINGTON STREET
BUFFALO, NEW YORK 14203

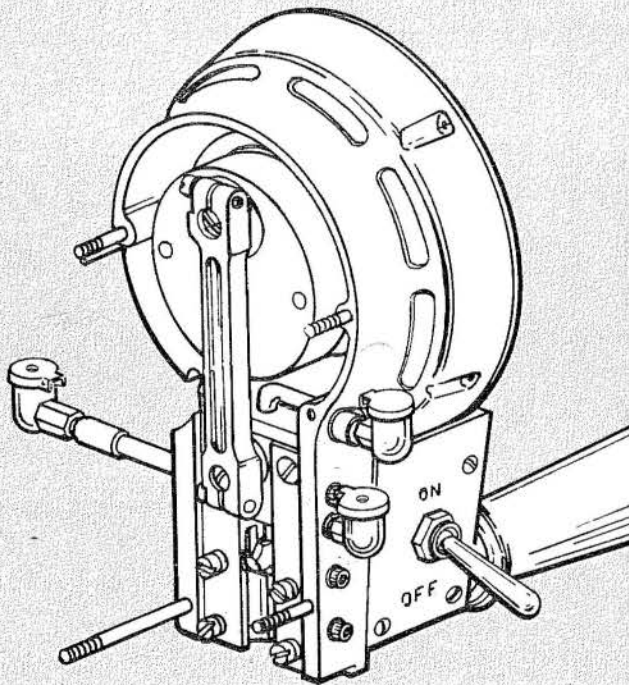

FRONT BEARING HOUSING ASSEMBLY

PLEASE SPECIFY
MACHINE CLASS NUMBER
AND SERIAL NUMBER
WHEN ORDERING PARTS

Part No.	Description
4C1-111	OPERATING HANDLE LOCK NUT
4C1-132	CRANK BALL BEARING LOCK NUT
4C1-190	LOCK NUT FOR SHAFT
4C2-91	NUT FOR GUIDE SCREW (3 Req'd.)
4C2-110	STOP NUT
4C3-8	GUIDE ADJUSTMENT NUT (3 Req'd.)
8C4-37	SWITCH INSULATION
11C12-92	SHAFT FOR BALL BEARING
12C1-21	SHAKEPROOF WASHER (2 Req'd.)
12C1-24	KNIFE LOCK WASHER
12C15-14	GUIDE WASHER (4 Req'd.)
12C15-53	CONNECTING ROD WASHER
15C13-23	STUD, UPPER (2 Req'd.)
15C13-34	STUD, LOWER L.H. MOUNTING
15C13-39	STUD, LOWER R.H. MOUNTING
17C4-6	WRIST PIN
20C5-17	CONNECTING ROD CLAMP SCREW (2 Req'd.)
20C12-62	FRONT HOUSING PLUG SCREW
20C12-79	SCREW FOR HANDLE BRACKET
20C12-122	GUIDE HOLD DOWN SCREW (2 Req'd.)
20C12-123	GUIDE HOLD DOWN SCREW (4 Req'd.)
20C13-4	SET SCREW
20C13-14	GUIDE LOCK SCREW (3 Req'd.)
20C13-15	GUIDE ADJUSTMENT SCREW (3 Req'd.)
24C1-3	KNIFE LOCK BOLT
34C10-142	SPRING FOR CAPACITOR
52C5-161	SWITCH BASE - SINGLE SPEED 1 & 3 PHASE
52C5-163	SWITCH BASE - DUAL SPEED 3 PHASE
52C5-162	SWITCH BASE - DUAL SPEED 1 PHASE
53C2-98	SWITCH COVER
53C11-91	CAPACITOR COVER
54C4-32	WRIST PIN PLUG
62C1-140	HANDLE BRACKET
70C1-71	R.H. GUIDE 1-1/8 STROKE
70C1-69	R.H. GUIDE 1-1/4 STROKE
70C1-67	R.H. GUIDE 1-1/2 STROKE
70C1-66	R.H. GUIDE 1-3/4 STROKE
70C1-72	L.H. GUIDE 1-1/8 STROKE
70C1-70	L.H. GUIDE 1-1/4 STROKE
70C1-68	L.H. GUIDE 1-1/2 STROKE
70C1-65	L.H. GUIDE 1-3/4 STROKE
71C3-18	FRONT BALL BEARING RETAINER
72C4-15	OIL CUP (1 Req'd.)
72C4-26	OIL CUP (2 Req'd.)
73C1-7	OIL TUBE, L.H. GUIDE
73C1-9	OIL TUBE, R.H. GUIDE
73C6-24	OIL TUBE FOR WRIST PIN
73C7-69	OIL TUBE FOR WRIST PIN
85C1-52	CRANK 1-1/8 STROKE
85C1-46	CRANK 1-1/4 STROKE
85C1-45	CRANK 1-1/2 STROKE
85C1-44	CRANK 1-3/4 STROKE
90C2-139	FRONT BEARING HOUSING
90C6	CRANK BALL BEARING
90C6-38	FRONT BALL BEARING
300C10-4	SCREW, 6-32 x 3/8 ROUND HD. (2 Req'd.)
300C12-3	SCREW, 8-32 x 3/8 ROUND HD. (1 Req'd.)
302C10-4	SCREW, 6-32 x 5/16 FLAT HD. (4 Req'd.)
305C8-1	SCREW, 4-40 x 1/4 BINDING HD. (9 Req'd.)
307C18-1	BUTTON HD. SCREW
531C1-53	OPERATING HANDLE
579C2-17	CROSS HEAD (With Lock Washer & Bolt)
580C1-52	SWITCH - DUAL SPEED 3 PHASE
580C1-65	SWITCH - SINGLE SPEED 3 PHASE
580C1-81	SWITCH - DUAL SPEED 1 PHASE
580C1-85	SWITCH, SINGLE SPEED 1 PHASE
664C1-6	CONNECTING ROD 1-1/8 STROKE
664C1-5	CONNECTING ROD 1-1/4 STROKE
664C1-4	CONNECTING ROD 1-1/2 STROKE
664C1-3	CONNECTING ROD 1-3/4 STROKE
706C1-4	CAPACITOR 110 VOLT
706C1-5	CAPACITOR 220 VOLT
727C1-5	OIL PAD HOLDER 1-1/8 - 1-1/4 - 1-1/2 STROKE
727C1-8	OIL PAD HOLDER 1-3/4 STROKE

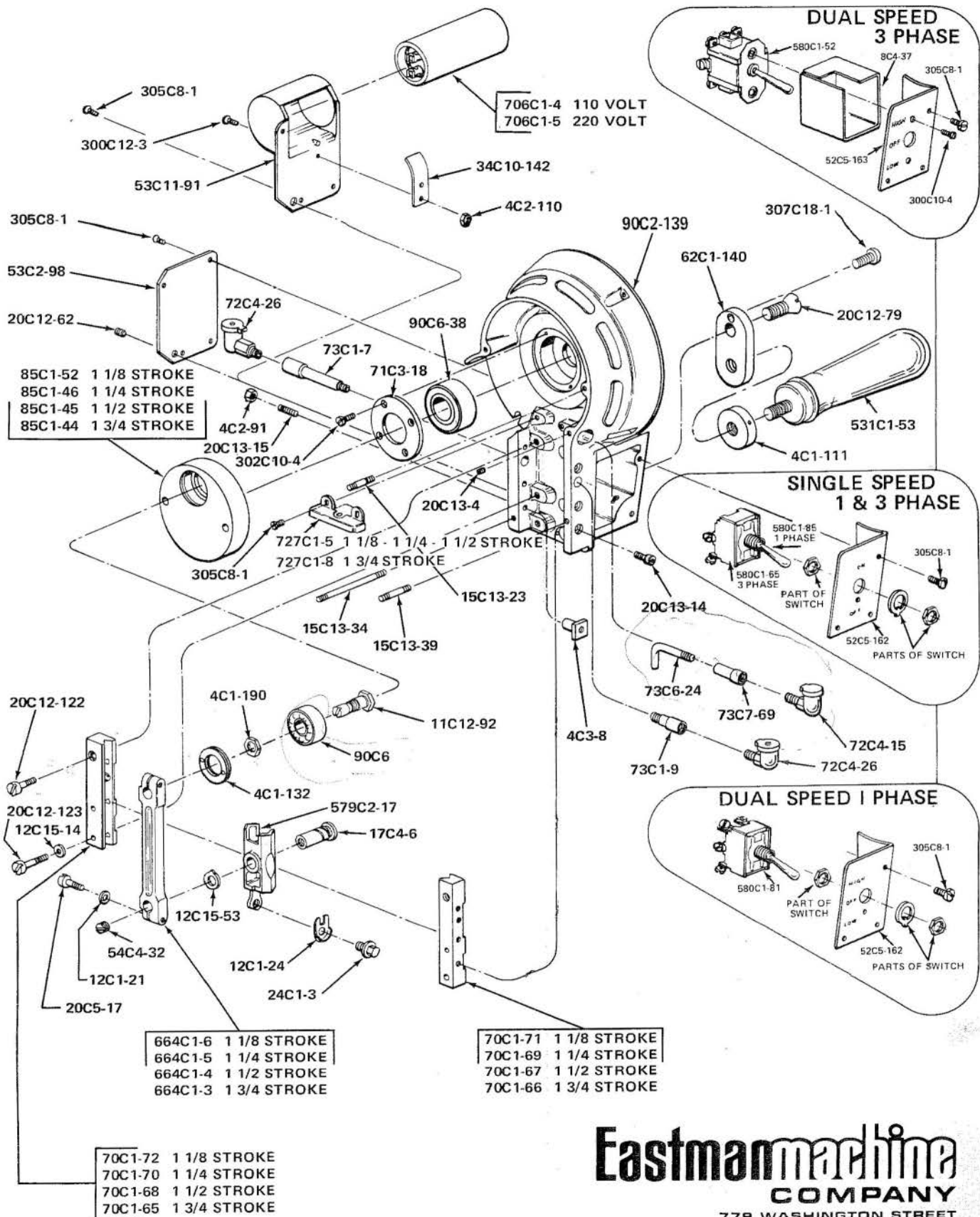

Eastman
machine
COMPANY
779 WASHINGTON STREET
BUFFALO, NEW YORK 14203

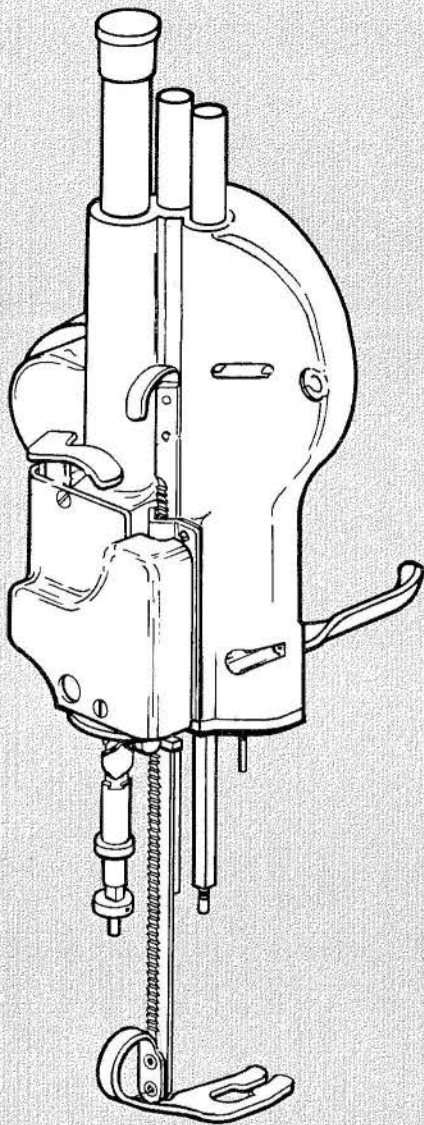

PLEASE SPECIFY
MACHINE CLASS NUMBER
AND SERIAL NUMBER
WHEN ORDERING PARTS

SHARPENER HOUSING ASSEMBLY

(FRONT VIEW)

Eastmanmachine COMPANY

779 WASHINGTON STREET
BUFFALO, NEW YORK 14203

Part No.	Description
4C1-149	STOP NUT FOR SCREW SHAFT
4C1-161	NUT FOR PRESSURE FOOT LOCK
4C2-112	R.H. NUT FOR SCREW SHAFT
4C2-113	L.H. NUT FOR SCREW SHAFT
5C5-16	COLLAR FOR EXTENSION
11C12-54	SHAFT FOR CAM
11C12-67	SCREW SHAFT 5" - 8" KNIFE
11C12-68	SCREW SHAFT 9" - 10" KNIFE
11C12-82	SCREW SHAFT 11½" - KNIFE
11C12-86	SCREW SHAFT 13" KNIFE
12C15-57	SPRING WASHER FOR RELEASE LEVER
12C15-69	WASHER FOR LOCK BRACKET
12C15-74	THRUST WASHER FOR NUTS (4 Req'd.)
12C15-91	THRUST WASHER - UPPER NUT (2 Req'd.)
17C15-106	ROLL PIN FOR COLLAR
20C4-17	PRESSURE FOOT LEVER SCREW
20C12-13	CAM SHAFT SPRING SCREW
20C12-113	SCREW FOR LATCH
20C12-117	SCREW FOR PRESSURE FOOT SHOE (2 Req'd.)
20C12-119	SCREW FOR RELEASE LEVER
20C12-137	SCREW FOR PRESSURE FOOT LOCK
22C3-2	LIFT HANDLE FOR PRESSURE FOOT ROD
34C1-20	CAM SPRING
34C8-12	SPRING FOR PRESSURE FOOT LOCK
34C10-100	SPRING FOR PRESSURE FOOT LEVER 5" - 13" KNIFE
34C10-107	SPRING FOR LATCH
53C11-72	COVER OVER CAM
55C4-49	SPACER FOR PRESSURE FOOT LOCK BRACKET
57C7-39	PRESSURE FOOT LEVER 5" - 13" KNIFE
66C1-54	SLIDE FOR PRESSURE FOOT ROD
68C1-192	PRESSURE FOOT SHOE, ALL STROKES
71C3-15	THRUST BALL BEARING (3 Req'd.)
86C7-34	CAP FOR TUBE
90C4-47	BEARING FOR CAM SHAFT (2 Req'd.)
97C3-35	LATCH FOR CAM
147C1-26	EXTENSION FOR SCREW SHAFT
171C1-16	LOCK (Only) FOR PRESSURE FOOT
300C10-1	SCREW, 6-32 x 3/16 ROUND HD. (2 Req'd.)
300C10-4	SCREW, 6-32 x 3/8 ROUND HD. (4 Req'd.)
302C10-4	SCREW, 6-32 x 5/16 FLAT HD. (1 Req'd.)
302C10-8	SCREW, 6-32 x 3/4 FLAT HD. (1 Req'd.)
309C15-7	SET SCREW FOR CAM
553C1-7	PRESSURE FOOT LOCK BRACKET COMPLETE
553C1-8	PRESSURE FOOT LOCK BRACKET ONLY
605C1-35	PRESSURE FOOT ROD 5" - 6" KNIFE
605C1-36	PRESSURE FOOT ROD 7" - 8" KNIFE
605C1-37	PRESSURE FOOT ROD 9" - 10" KNIFE
605C1-33	PRESSURE FOOT ROD 11½" KNIFE
605C1-34	PRESSURE FOOT ROD 13" KNIFE
621C1-7	RELEASE LEVER WITH CAM
713C4-4	SCREW SHAFT WITH EXTENSION, R. & L. HAND NUTS 5" - 8"
713C4-5	SCREW SHAFT WITH EXTENSION, R. & L. HAND NUTS 9" - 10"
713C4-6	SCREW SHAFT WITH EXTENSION, R. & L. HAND NUTS 11½"
713C4-7	SCREW SHAFT WITH EXTENSION, R. & L. HAND NUTS 13"
732C1-11	SHARPENER HOUSING (With bushings and tubes) ONLY 5" - 8" KNIFE
732C1-12	SHARPENER HOUSING (With bushings and tubes) ONLY 9" - 10" KNIFE
732C1-20	SHARPENER HOUSING (With bushings and tubes) ONLY 11½" KNIFE
732C1-17	SHARPENER HOUSING (With bushings and tubes) ONLY 13" KNIFE

* THESE PARTS SOLD ONLY IN ASSEMBLYS AS FOLLOWS.

- 713C4-4 Screw Shaft with extension, R. & L. Hand Nuts 5" - 8"
- 713C4-5 Screw Shaft with extension, R. & L. Hand Nuts 9" - 10"
- 713C4-6 Screw Shaft with extension, R. & L. Hand Nuts 11½"
- 713C4-7 Screw Shaft with extension, R. & L. Hand Nuts 13"

FOR
SPACER
CHART
(SEE
SHARPENER
HOUSING
ASSEMBLY
DRAWING)
(REAR VIEW)
PAGE 19

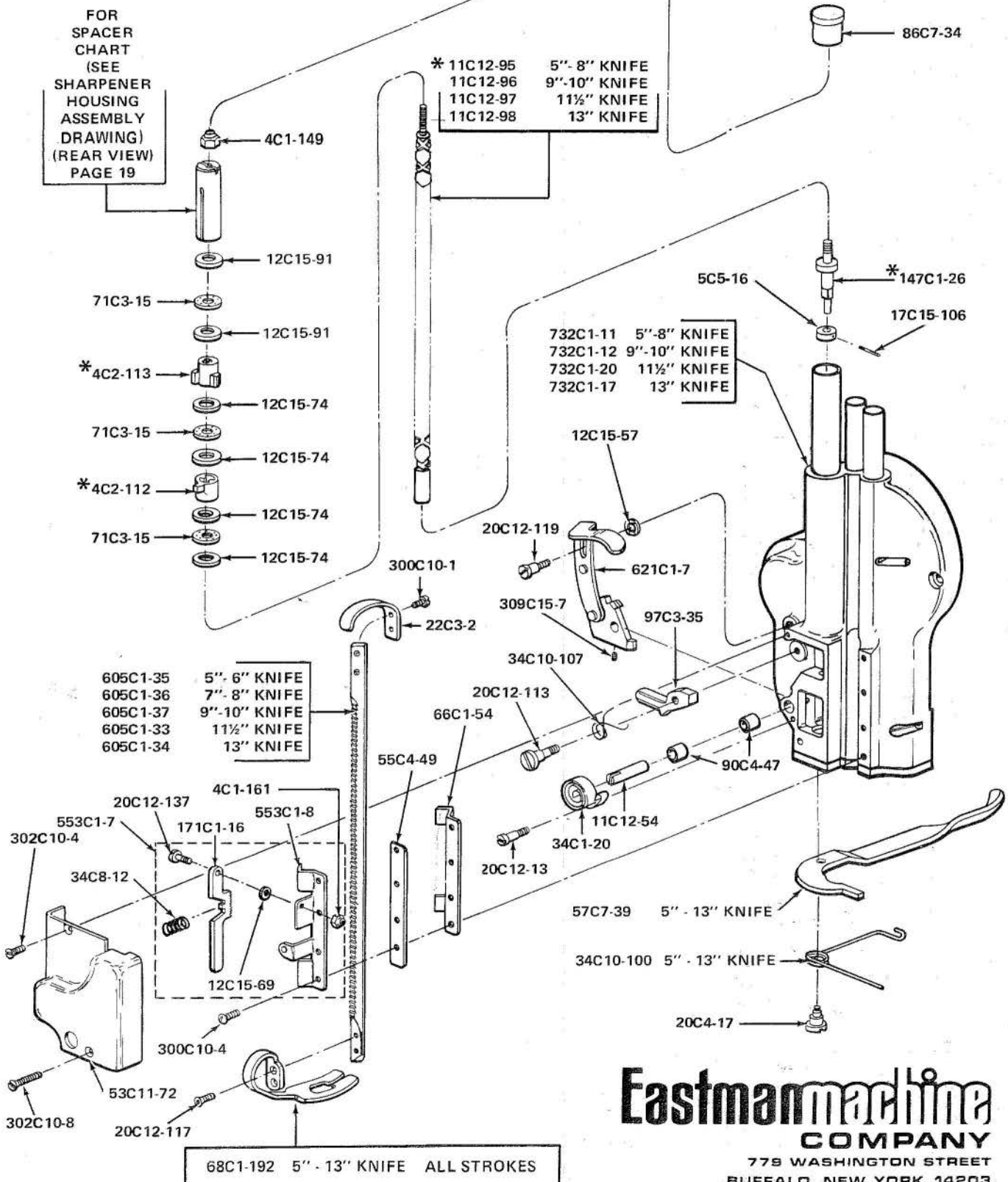

Eastmanmachine
COMPANY
779 WASHINGTON STREET
BUFFALO, NEW YORK 14203

Eastmanmachine COMPANY

779 WASHINGTON STREET
BUFFALO, NEW YORK 14203

SHARPENER HOUSING ASSEMBLY (REAR VIEW)

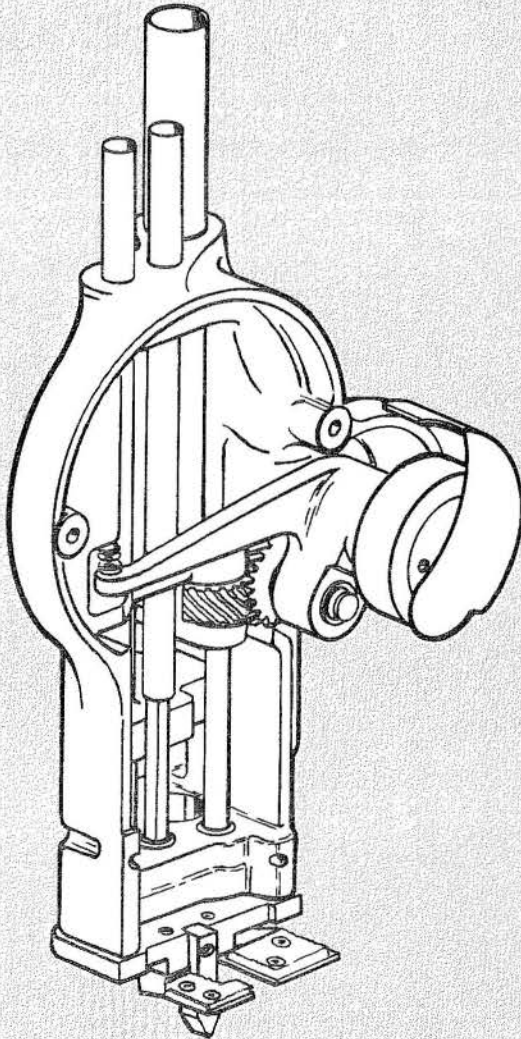

PLEASE SPECIFY
MACHINE CLASS NUMBER
AND SERIAL NUMBER
WHEN ORDERING PARTS

Part No.	Description
4C2-2	LOCK NUT FOR SHAFT
4C2-85	R.H. FOLLOWER NUT
4C2-86	L.H. FOLLOWER NUT
11C12-58	R.H. SQUARE SHAFT 5" - 8" KNIFE
11C12-59	R.H. SQUARE SHAFT 9" - 10" KNIFE
11C12-81	R.H. SQUARE SHAFT 11½" KNIFE
11C12-85	R.H. SQUARE SHAFT 13" KNIFE
11C12-56	L.H. SQUARE SHAFT 5" - 8" KNIFE
11C12-57	L.H. SQUARE SHAFT 9" - 10" KNIFE
11C12-80	L.H. SQUARE SHAFT 11½" KNIFE
11C12-84	L.H. SQUARE SHAFT 13" KNIFE
11C12-64	SHAFT FOR CRANK
12C15-29	THRUST WASHER (2 Req'd.)
12C15-30	THRUST WASHER FOR BOTTOM PLATE (2 Req'd.)
12C15-52	WASHER FOR SHAFT
17C15-78	PIN FOR BELL CRANK
17C15-82	PIN FOR SHARPENER HOUSING
17C15-103	ROLL PIN FOR PUSH ROD
17C15-113	SPREADER PIN
18C6-8	RETAINING RING FOR SHAFT
18C6-26	RETAINING RING FOR BELL CRANK
34C10-89	SPRING FOR BELL CRANK
53C11-60	COVER FOR DRIVER
55C4-41	SPACER FOR BALL BEARINGS
57C7-46	RELEASE LEVER
62C16-151	SHARPENER HOUSING (Only)
65C6-75	PUSH ROD
73C7-46	TUBE FOR SQUARE SHAFTS 4" - 8" KNIFE
73C7-47	TUBE FOR SQUARE SHAFTS 9" - 10" KNIFE
73C7-86	TUBE FOR SQUARE SHAFTS 11½" KNIFE
73C7-88	TUBE FOR SQUARE SHAFTS 13" KNIFE
73C7-48	TUBE FOR SCREW SHAFT 4" - 8" KNIFE
73C7-49	TUBE FOR SCREW SHAFT 9" - 10" KNIFE
73C7-85	TUBE FOR SCREW SHAFT 11½" KNIFE
73C7-87	TUBE FOR SCREW SHAFT 13" KNIFE
79C12-163	BOTTOM PLATE
85C3-3	BELL CRANK (Only)
87C3-40	IDLER GEAR
87C3-44	SPUR GEAR (2 Req'd.)
87C3-53	GEAR AND SHAFT
90C4-29	BEARING FOR DRIVE SHAFT (Lower)
90C4-33	BEARING FOR GEARS (2 Req'd.)
90C4-34	BEARING FOR BELL CRANK
90C4-42	BEARING FOR DRIVE SHAFT
90C4-48	BEARING FOR DRIVE SHAFT (Upper)
90C4-58	BEARING FOR SCREW SHAFT
90C6-24	BALL BEARING FOR CRANK (2 Req'd.)
300C7-2	SCREW, 4-36 x 3/16 ROUND HD. (2 Req'd.)
300C10-1	SCREW, 6-32 x 3/16 ROUND HD. (2 Req'd.)
300C12-3	SCREW, 8-32 x 3/8 ROUND HD. (2 Req'd.)
302C10-6	SCREW, 6-32 x 1/2 FLAT HD. (1 Req'd.)
302C12-3	SCREW, 8-32 x 3/8 FLAT HD. (3 Req'd.)
584C2-3	BELL CRANK WITH PIN & BEARING (Only)
584C3-16	BELL CRANK COMPLETE WITH LEVER
602C1-9	DRIVER PULLEY WITH DRIVER
716C1-12	DRIVER SHAFT WITH GEAR
724C1-3	L.H. SPIRAL GEAR WITH KEY
727C1-6	OIL PAD & HOLDER

4C2-86

4C2-85

11C12-58 5"- 8" KNIFE
 11C12-59 9"-10" KNIFE
 11C12-81 11½" KNIFE
 11C12-85 13" KNIFE

73C7-46 4"- 8" KNIFE
 73C7-47 9"-10" KNIFE
 73C7-86 11½" KNIFE
 73C7-88 13" KNIFE

73C7-48 5"- 8" KNIFE
 73C7-49 9"-10" KNIFE
 73C7-85 11½" KNIFE
 73C7-87 13" KNIFE

11C12-56 5"- 8" KNIFE
 11C12-57 9"-10" KNIFE
 11C12-80 11½" KNIFE
 11C12-84 13" KNIFE

SPACER CHART For Automatic Sharpeners

STROKE	KNIFE SIZE	SPACER NUMBER	SPACER LENGTH
1 1/8 - 1 1/4	5	73C7-55	3 7/8
1 1/2 - 1 3/4	5	73C7-56	4 1/4
1 1/8 - 1 1/4	6	73C7-57	2 7/8
1 1/2 - 1 3/4	6	73C7-58	3 1/4
1 1/8 - 1 1/4	7	73C7-59	1 7/8
1 1/2 - 1 3/4	7	73C7-60	2 1/4
1 1/8 - 1 1/4	8	1C13-12	15/16
1 1/2 - 1 3/4	8	1C13-13	1 1/4
1 1/8 - 1 1/4	9	73C7-59	1 7/8
1 1/2 - 1 3/4	9	73C7-60	2 1/4
1 1/8 - 1 1/4	10	1C13-12	15/16
1 1/2 - 1 3/4	10	1C13-13	1 1/4
1 1/8 - 1 1/4	11 1/2	1C13-12	15/16
1 1/2 - 1 3/4	11 1/2	1C13-13	1 1/4
1 1/8 - 1 1/4	13	1C13-12	15/16
1 1/2 - 1 3/4	13	1C13-13	1 1/4

62C16-151

53C11-60

300C7-2

4C2-2

11C12-64

87C3-40

87C3-53

584C3-16 BELL CRANK COMPLETE WITH LEVER
 584C2-3 BELL CRANK WITH PIN & BRG. ONLY
 85C3-3 BELL CRANK ONLY

17C15-82

34C10-89

90C4-48

12C15-29

724C1-3

12C15-29

90C4-42

90C4-33

87C3-44

12C15-30

90C4-33

87C3-44

12C15-30

65C6-75

90C4-29

716C1-12

55C4-41

90C6-24

90C6-24

18C6-26

602C1-9

17C15-78

90C4-34

18C6-8

12C15-52

90C4-58

17C15-103

79C12-163

302C12-3

727C1-6

300C10-1

302C10-6

17C15-113

300C12-3

57C7-46

Eastmanmachine COMPANY

779 WASHINGTON STREET
 BUFFALO, NEW YORK 14203

PLEASE SPECIFY
MACHINE CLASS NUMBER
AND SERIAL NUMBER
WHEN ORDERING PARTS

LOWER GEAR BRACKET ASSEMBLY

EASTMAN'S NEW PRE-SET SHARPENER
SHOES ILLUSTRATED
PATENT PENDING
FOR OPTIONAL BEVEL BLOC® SHOES
SEE LAST PAGE

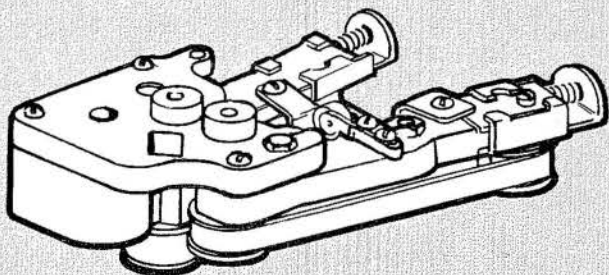

Eastmanmachine
COMPANY

778 WASHINGTON STREET
BUFFALO, NEW YORK 14203

Part No.	Description
715C1-22	LOWER GEAR BRACKET (Complete) 5" - 10" KNIFE
715C1-23	LOWER GEAR BRACKET (Complete) 11½" - 13" KNIFE
4C1-189	JAM NUT
4C2-63	NUT FOR SHARPENER SHOE SCREW (2 Req'd.)
12C15-94	THREADED WASHER (2 Req'd.)
17C15-106	ROLL PIN (For Pulley 152C1-19) (2 Req'd.)
20C6-25	ADJUSTING SCREW
20C12-57	SCREW FOR SHARPENER SHOE (Wave knife only) (2 Req'd.)
20C12-143	SCREW FOR CLAMPING ARM
20C12-153	SCREW FOR SHARPENER SHOE (2 Req'd.)
21C13-17	BUSHING FOR SHARPENER SHOE (2 Req'd.)
34C10-45	SPRING FOR PULLEY SLIDE (2 Req'd.)
34C10-47	L.H. SHARPENER SHOE SPRING (Wave knife only)
34C10-57	R.H. SHARPENER SHOE SPRING (Wave knife only)
34C10-123	SPRING FOR ARM
34C10-148	L.H. SHARPENER SHOE SPRING
34C10-149	R.H. SHARPENER SHOE SPRING
35C7-28	CLAMPING ARM FOR SHOE
53C4-78	GEAR COVER
54C4-35	GREASE PLUG
70C4-32	GUIDE BACK OF STANDARD
79C12-218	WEAR PLATE 5" - 10" KNIFE (2 Req'd.)
79C12-219	WEAR PLATE 11½" - 13" KNIFE (2 Req'd.)
87C3-50	GEAR ON SCREW SHAFT
87C5-13	INTERMEDIATE GEAR
90C4-47	BEARING FOR INTERMEDIATE GEAR
90C4-51	BEARING FOR SCREW SHAFT
90C4-59	BEARING FOR SHAFT EXTENSION (2 Req'd.)
147C1-28	R.H. SHAFT EXTENSION
147C1-29	L.H. SHAFT EXTENSION
152C1-19	FRONT PULLEY FOR BELT (2 Req'd.)
209C1	NEOPRENE BAND FOR PULLEY (2 Req'd.)
300C7-3	SCREW, 4-36 x 1/4 ROUND HD. (4 Req'd.)
300C10-2	SCREW, 6-32 x 1/4 ROUND HD. (2 Req'd.)
300C10-6	SCREW, 6-32 x 1/2 ROUND HD. (3 Req'd.)
301C7-2	SCREW, 4-36 x 3/16 FILLISTER HD. (2 Req'd.)
301C10-3	SCREW, 6-32 x 3/8 FILLISTER HD. (1 Req'd.)
309C12-2	ADJUSTING SCREW, L.H. SHOE
712C1	R.H. SLIDE WITH PULLEY
712C1-1	L.H. SLIDE WITH PULLEY
715C1-19	LOWER GEAR BRACKET WITH COVER 5" - 10" KNIFE
715C1-20	LOWER GEAR BRACKET WITH COVER 11½" - 13" KNIFE
728C1-5	STABILIZER (2 Req'd.)
743C1-26	R.H. SHOE (Wave knife only)
743C1-27	L.H. SHOE (Wave knife only)
743C1-28	R.H. PRE-SET SHARPENER SHOE
743C1-29	L.H. PRE-SET SHARPENER SHOE

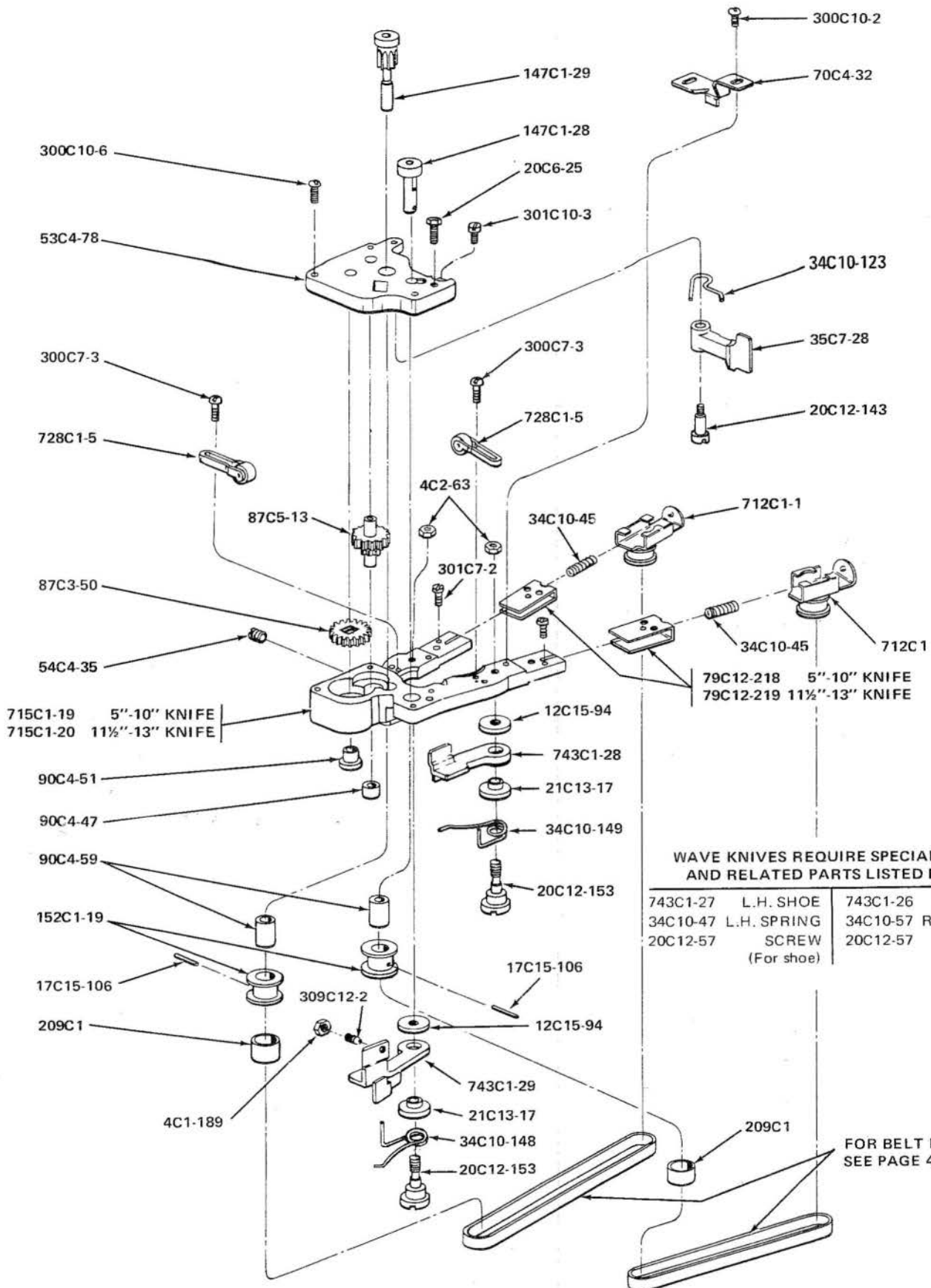

WAVE KNIVES REQUIRE SPECIAL SHOES AND RELATED PARTS LISTED BELOW

743C1-27	L.H. SHOE	743C1-26	R.H. SHOE
34C10-47	L.H. SPRING	34C10-57	R.H. SPRING
20C12-57	SCREW (For shoe)	20C12-57	SCREW (For shoe)

FOR BELT LISTING
SEE PAGE 4

715C1-22 LOWER GEAR BRACKET COMPLETE FOR 5"-10" KNIFE
715C1-23 LOWER GEAR BRACKET COMPLETE FOR 11½"-13" KNIFE

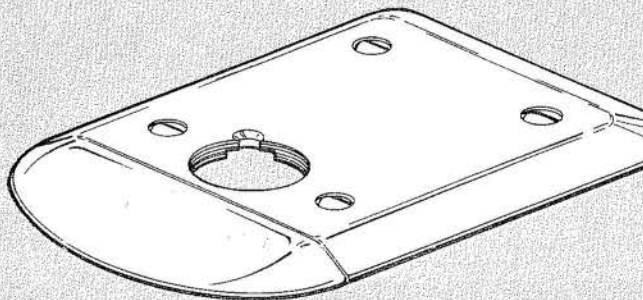
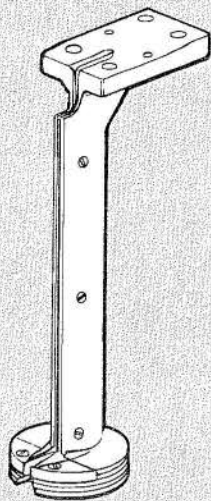

PLEASE SPECIFY
MACHINE CLASS NUMBER
AND SERIAL NUMBER
WHEN ORDERING PARTS

STANDARD, AND BASE PLATE ASSEMBLY

Eastmanmachine COMPANY

779 WASHINGTON STREET
BUFFALO, NEW YORK 14203

Part No.	Description
12C1-35	LOCK WASHER (4 Req'd.)
17C6-9	HINGE PIN (2 Req'd.)
20C5-12	CLAMP SCREW FOR ROLLERS (8 Req'd.)
20C12-19	KNIFE SLIDE SCREW
20C13-51	HINGE PIN CLAMP SCREW (4 Req'd.)
34C1-57	PLATE WING TENSION SPRING (2 Req'd.)
60C1-55	PLATE WING (For Small Plates)
60C1-56	PLATE WING (For Large Plates)
79C4-12/13	THROAT PLATES WITH SCREWS AND PINS
505C3-223	SMALL PLATE COMPLETE (5" - 10" KNIFE)
505C3-224	LARGE PLATE COMPLETE (11½" - 13" KNIFE)
505C3-226	SMALL PLATE COMPLETE (5" - 10" KNIFE) FOR 50 CY. 1500 R.P.M. & DUAL SPEED ONLY
505C3-227	LARGE PLATE COMPLETE (11½" - 13" KNIFE) FOR 50 CY. 1500 R.P.M. & DUAL SPEED ONLY
528C1-123	STANDARD (Complete with slides and throat plates) 5" KNIFE
528C1-120	STANDARD (Complete with slides and throat plates) 6" KNIFE
528C1-122	STANDARD (Complete with slides and throat plates) 7" KNIFE
528C1-121	STANDARD (Complete with slides and throat plates) 8" KNIFE
528C1-115	STANDARD (Complete with slides and throat plates) 9" KNIFE
528C1-116	STANDARD (Complete with slides and throat plates) 10" KNIFE
528C1-124	STANDARD (Complete with slides and throat plates) 11½" KNIFE
528C1-125	STANDARD (Complete with slides and throat plates) 13" KNIFE
532C2-5	RUBBER MOUNTED ROLLER (Complete) (4 Req'd.)
532C2-7	RUBBER MOUNTED ROLLER (Complete) (4 Req'd.)
619C1-31	ROLLER SHELL (Complete) (4 Req'd.)
643C1-44	KNIFE SLIDES (Complete with screws) 5" KNIFE
643C1-41	KNIFE SLIDES (Complete with screws) 6" KNIFE
643C1-42	KNIFE SLIDES (Complete with screws) 7" KNIFE
643C1-43	KNIFE SLIDES (Complete with screws) 8" KNIFE
643C1-46	KNIFE SLIDES (Complete with screws) 9" KNIFE
643C1-47	KNIFE SLIDES (Complete with screws) 10" KNIFE
643C1-53	KNIFE SLIDES (Complete with screws) 11½" KNIFE
643C1-45	KNIFE SLIDES (Complete with screws) 13" KNIFE

528C1-123	5" STANDARD
528C1-120	6" STANDARD
528C1-122	7" STANDARD
528C1-121	8" STANDARD
528C1-115	9" STANDARD
528C1-116	10" STANDARD
528C1-124	11½" STANDARD
528C1-125	13" STANDARD

INSTRUCTIONS FOR REMOVING WORN PLATE ROLLER SHELL

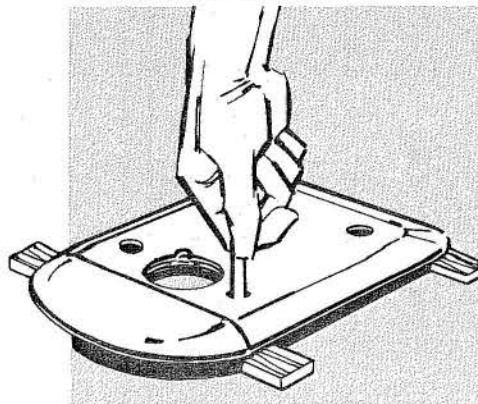

Place plate on blocks and press out roller shell from ring assembly, as shown.

Roller shell (complete with shaft and bearings) may be ordered as required – Specify Part No. 619C1-30.

Note: To install new plate roller shell reverse above procedure with base plate inverted.

KNIFE SLIDES

643C1-44	5" KNIFE
643C1-41	6" KNIFE
643C1-42	7" KNIFE
643C1-43	8" KNIFE
643C1-46	9" KNIFE
643C1-47	10" KNIFE
643C1-53	11½" KNIFE
643C1-45	13" KNIFE

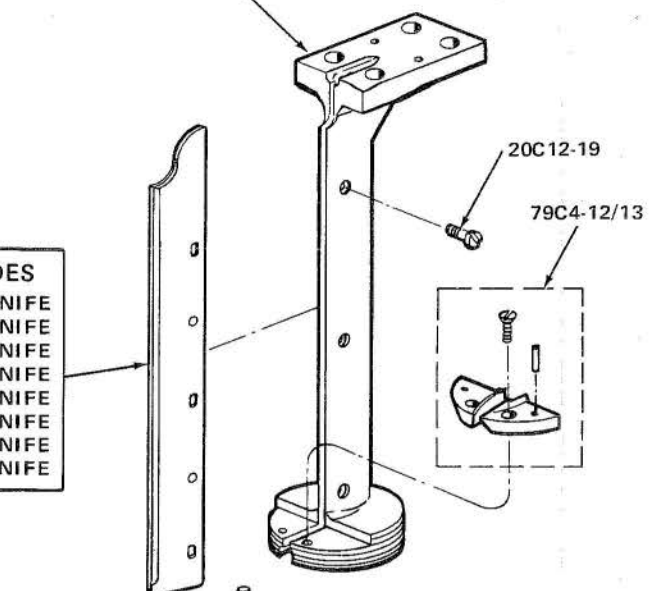

WARNING

Do not oil
plate roller shells.

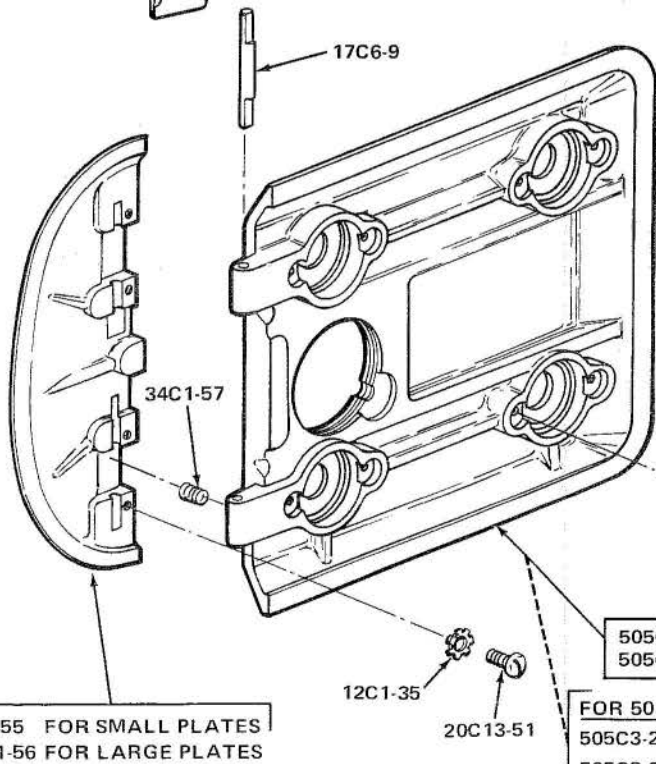

532C2-5 RUBBER MOUNTED ROLLER
(For All Machines Except
Noted Below)

532C2-7 RUBBER MOUNTED ROLLER
(For 50 CY. 1500 R.P.M. and
Dual Speed Machines Only)

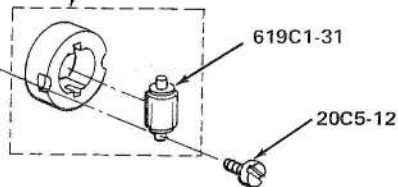

60C1-55 FOR SMALL PLATES
60C1-56 FOR LARGE PLATES

505C3-223 SMALL PLATE FOR 5"-8" KNIVES
505C3-224 LARGE PLATE FOR 9"-13" KNIVES

FOR 50 CY. 1500 R.P.M. & DUAL SPEED MACHINES ONLY
505C3-226 SMALL PLATE FOR 5"-8" KNIVES
505C3-227 LARGE PLATE FOR 9"-13" KNIVES

FOR COMPLETE LIST OF
EASTMAN KNIVES AVAILABLE
SEE PAGE 5.

**Eastmanmachine
COMPANY**

OPTIONAL BEVEL-BLOC® SHARPENER SHOES

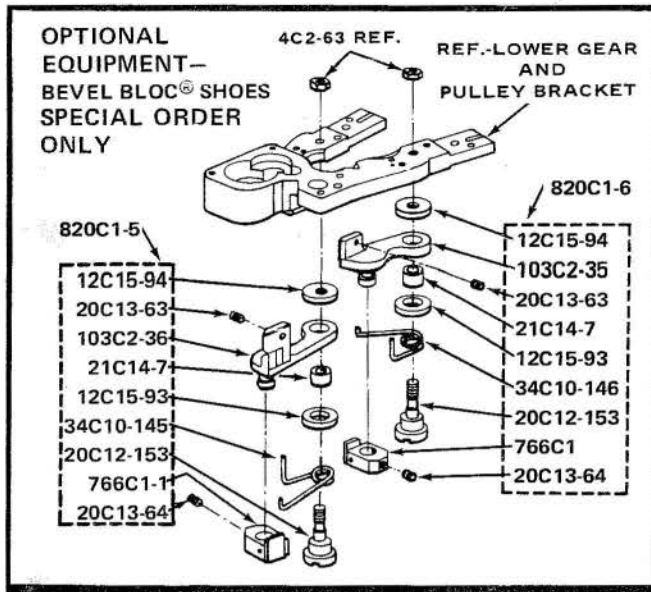

Part No.	Description
4C2-63	L.H. Nut (1 Req'd)
12C15-93	L.H. Washer (1 Req'd)
12C15-94	L.H. Washer - Threaded (1 Req'd)
20C12-153	L.H. Screw for Shoe (1 Req'd)
20C13-63	L.H. Set Screw (1 Req'd)
20C13-64	L.H. Set Screw (1 Req'd)
21C14-7	L.H. Bushing (1 Req'd)
34C10-145	L.H. Spring (1 Req'd)
103C2-36	L.H. Sharpener Shoe (1 Req'd)
766C1-1	L.H. Bevel Block (1 Req'd)
820C1-5	Conversion Kit Complete - L.H. Shoe (1 Req'd.)

4C2-63	R.H. Nut (1 Req'd)
12C15-93	R.H. Washer (1 Req'd)
12C15-94	R.H. Washer - Threaded (1 Req'd)
20C12-153	R.H. Screw for Shoe (1 Req'd)
20C13-63	R.H. Set Screw (1 Req'd)
20C13-64	R.H. Set Screw (1 Req'd)
21C14-7	R.H. Bushing (1 Req'd)
34C10-146	R.H. Spring (1 Req'd)
103C2-35	R.H. Sharpener Shoe (1 Req'd)
766C1	R.H. Bevel Block (1 Req'd)
820C1-6	Conversion Kit Complete - R.H. Shoe (1 Req'd.)

EASTMAN'S BEVEL BLOC® SHARPENER ASSEMBLY IS COVERED BY PATENT NOS. 2,829,474 AND 3,350,818

TO ADJUST BEVEL BLOC® SHOES Eastman's exclusive patented adjustable Bevel-Bloc sharpener shoes make it possible to grind any desired bevel on the knife edge. The knife edge bevel on your new machine is factory set to handle all normal fabrics and should not be changed. Nor-

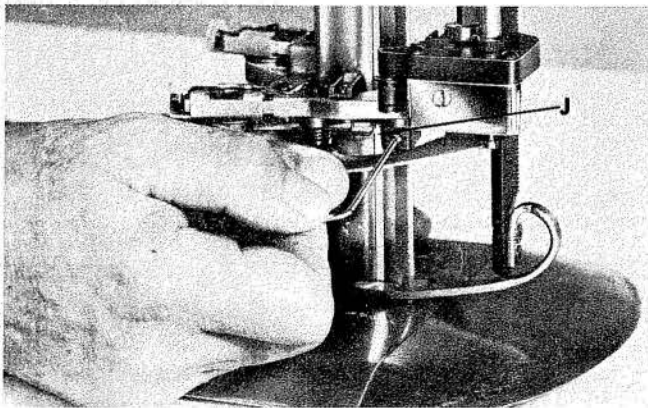

mally an acceptable bevel is 1/16" wide. If necessary to adjust the bevel on the knife edge to a different length proceed as follows:

Refer to diagram on page 3 and lower the knife to the bottom of the stroke with machine turning knob F. Lower the sharpener by hand, by holding the sharpener operating lever E halfway down to its neutral position. To change cutting bevel on knife, pull sharpener belt down to expose set screw on Bevel-Bloc. Insert Allen Key J into set screw and loosen slightly. For longer bevel on knife edge, move key and bloc to the rear; for shorter bevel, to the front. Retighten set screw. Adjust Bevel-Blocs on both shoes. After adjustment of Bevel-Blocs, return sharpener to top (locked) position. Check stop screws on sharpener shoes for correct setting as outlined in instructions on page 4. Color mark front sides of knife edge with marking ink or pencil. Turn on power and run sharpener down and up several times and then check bevel on both sides of knife. Re-adjust if necessary.

GUARANTEE

We guarantee our machines for six months from date of invoice against defective parts and workmanship and will repair or replace any machine going wrong from these causes when returned to us carrying charges prepaid.

This guarantee does not contemplate making good damage caused by misuse or neglect; and is void if other than genuine Eastman knives, abrasive belts and parts are used in the machine.

Eastmanmachine COMPANY

779 WASHINGTON STREET
BUFFALO, NEW YORK 14203
AREA CODE (716) 856-2200